

DOBIKON 1013
Installation Manual

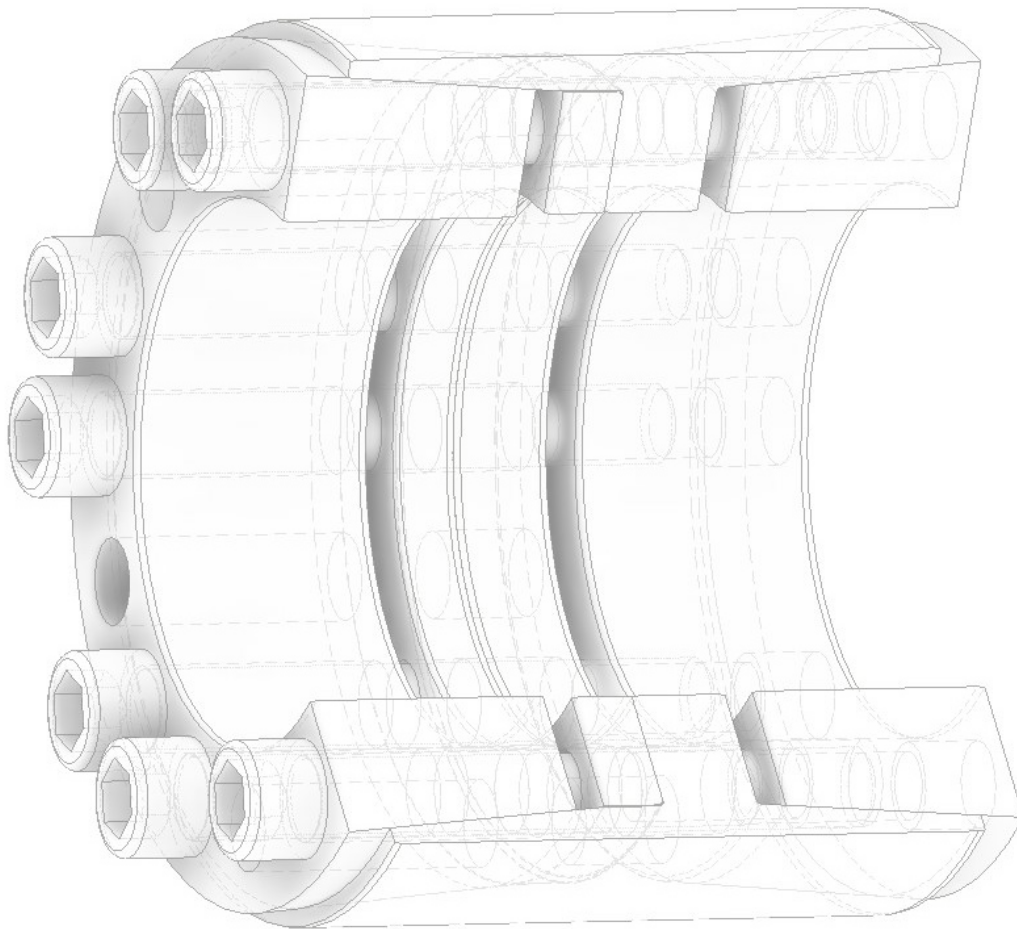

Only available from BIKON-Technik GmbH • 41468 Neuss • Germany

A Development of BIKON-Technik GmbH - introduction on global market in year 1974

Index:

We reserve all rights with regard to this technical data and its content. Without our prior written approval it is not allowed to duplicate this technical data or parts of it, nor to grant access to it by third parties or to exploit it otherwise (including extracts) without authority.

All topics and specification dealt with are only valid for original „BIKON“ or „DOBIKON“ products.

We will not accept any liability for damages arising from misinterpretation, application or constructional flaws (regarding equipment wherein our products shall be installed). All information is based upon our knowledge of the current state of the art at the draft date of this technical data.

We refer to our trademark and further intellectual property rights as well as our conditions of sale that shall apply.

April 2023

Schematic sketch

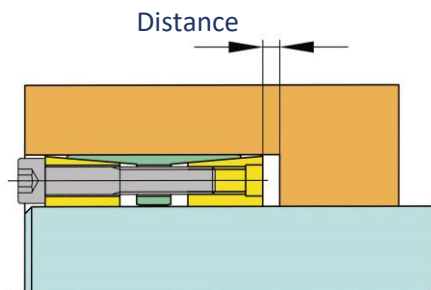

Space - generally

By use of stepped bores the locking assembly should never be pushed to block against the hub. There must be let distance about 2 – 5 mm to the hub to be able to remove the rings from each other. This applies to all BIKON locking assemblies.

Shafts with keyways

DOBIKON Locking assemblies can be tighten over keyways (according to DIN) on shafts. The function of the locking assembly is not affected.

Keyways in the hub are not allowed !

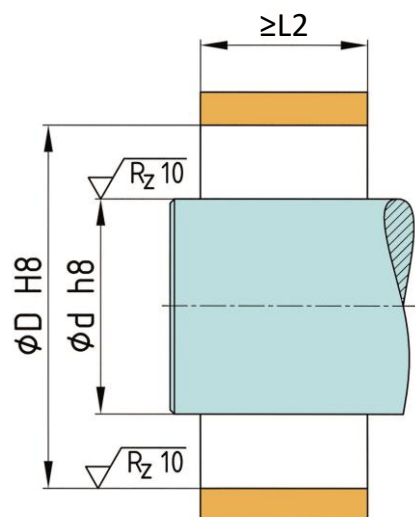

Space - DOBIKON 1013

d	D	L2
mm	mm	mm
180	285	229
200	305	229
220	325	229
240	355	238
260	375	238
280	405	238
300	425	280
320	455	280
340	475	280
360	495	280
380	515	280

d	D	L2
mm	mm	mm
400	535	280
420	555	280
440	575	280
460	595	280
480	615	280
500	635	280
520	655	280
540	675	280
560	695	280
580	715	280
600	735	280

TA – Tightening torque of screws

d	M	TA
mm	-	Nm
180	M22	930
200	M22	930
220	M22	930
240	M24	1200
260	M24	1200
280	M24	1200
300	M24	1200
320	M27	1 800
340	M27	1 800
360	M27	1 800
380	M27	1 800

d	M	TA
mm	-	Nm
400	M27	1 800
420	M27	1 800
440	M27	1 800
460	M27	1 800
480	M27	1 800
500	M27	1 800
520	M27	1 800
540	M27	1 800
560	M27	1 800
580	M27	1 800
600	M27	1 800

Installation

1.

DOBIKON locking assemblies are delivered ready for installation and oiled. The screws have been unscrewed a few threads.

Make sure that the rings fit loosely on top of each other (self-locking cone).

If the locking assembly is to be dismantled into its individual parts, please mark the position of the rings in relation to each other!

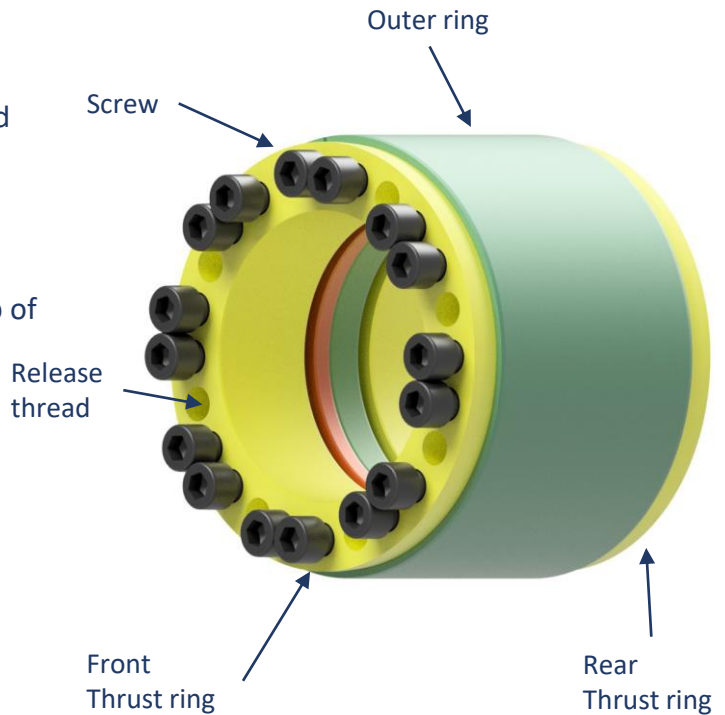

2.

Oil the shaft and hub and push the locking assembly into the installation space.

Do not use molybdenum disulfide (MoS₂), assembly paste or grease!

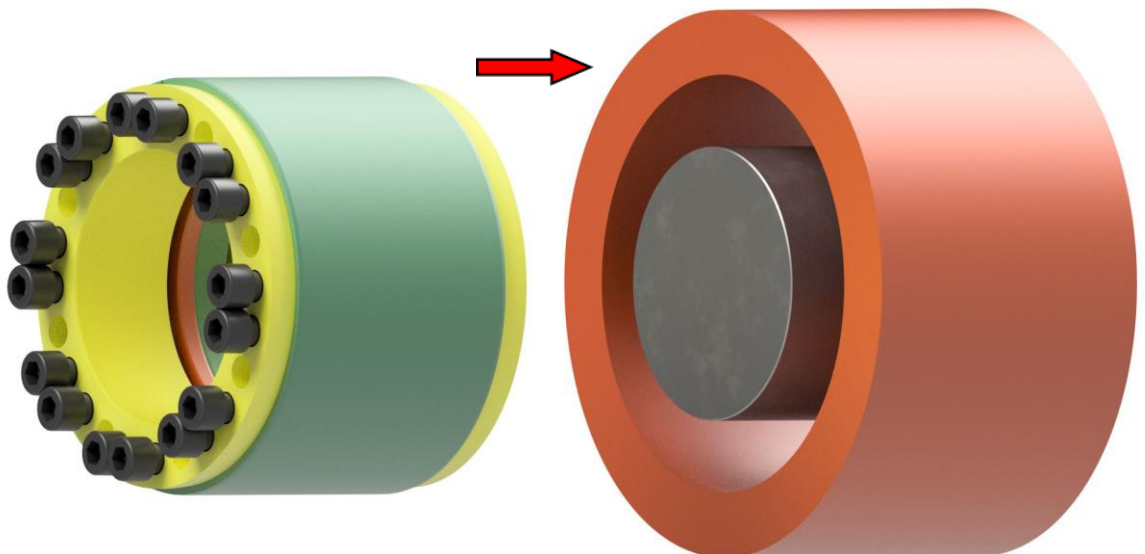

Installation

3.

The locking assembly must sit flush with the hub.

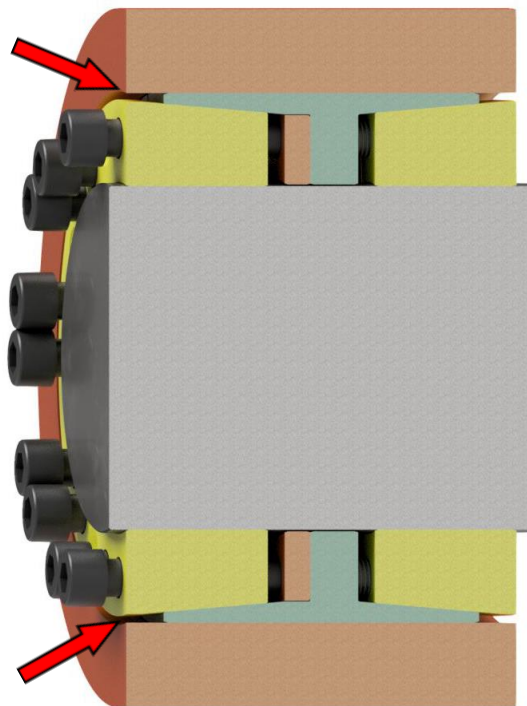

4.

Tighten the screws evenly crosswise and in several stages using a torque wrench.

control !

The tightening of the screws and the assembly is complete when no more screws can be tightened with the 100% tightening torque.

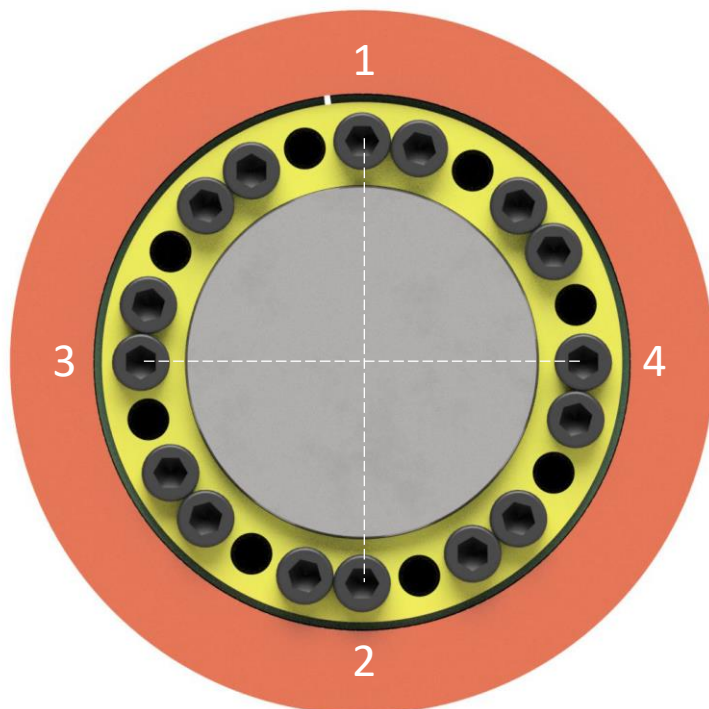

Installation

5.

By tightening the screws, the thrust rings slides and tightens the connection. The cone is self-locking and will not loosen by itself if the screws are loosened if it is operated properly.

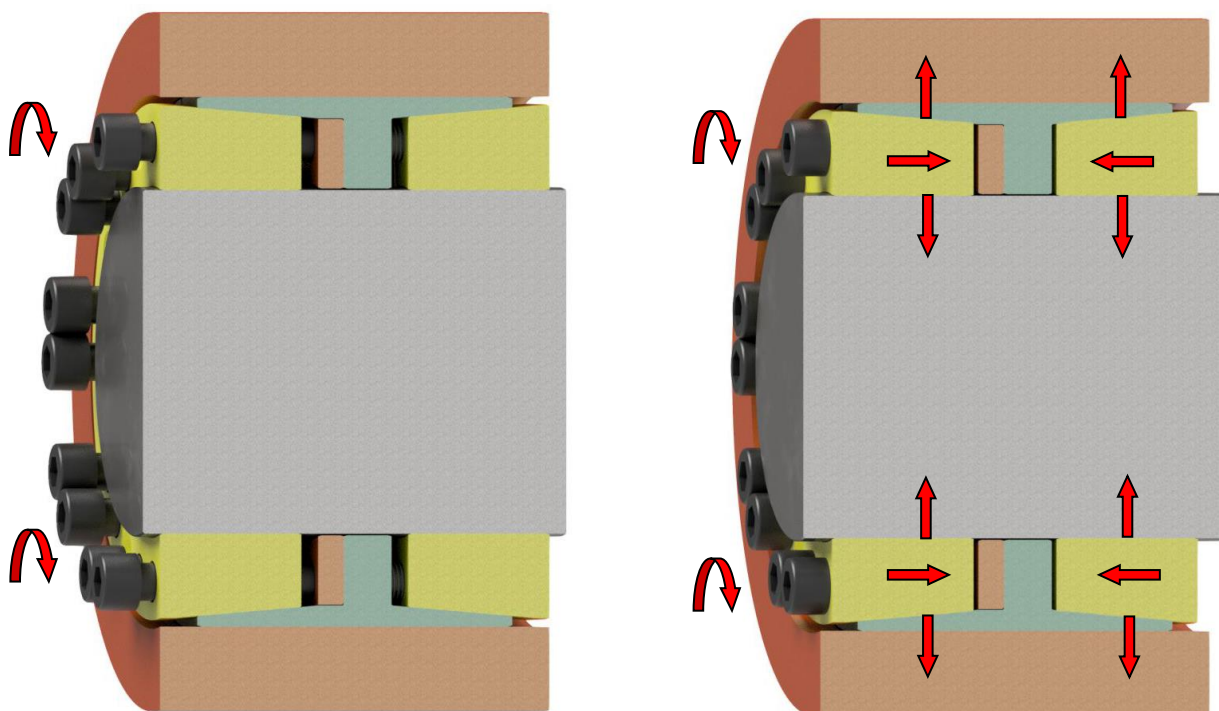

The locking assembly is maintenance-free and the screws do not have to be tightened after a certain period of operation.

Removal

1.

Loosen all screws and unscrew all screws-

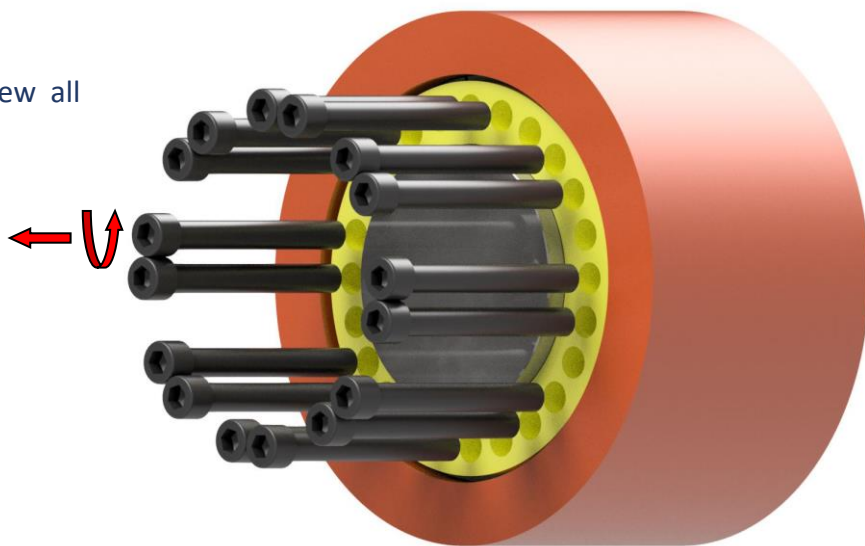

2.

Oil the screws and screw them into the release threads of the front thrust ring and tighten them crosswise with a torque wrench until the front thrust ring slides off the shaft and outer ring.

Important !

The shaft must be clean and free of particles. The thrust rings slide on the shaft when loosened.

(Grind the release screws flat on the face side before screwing them in)

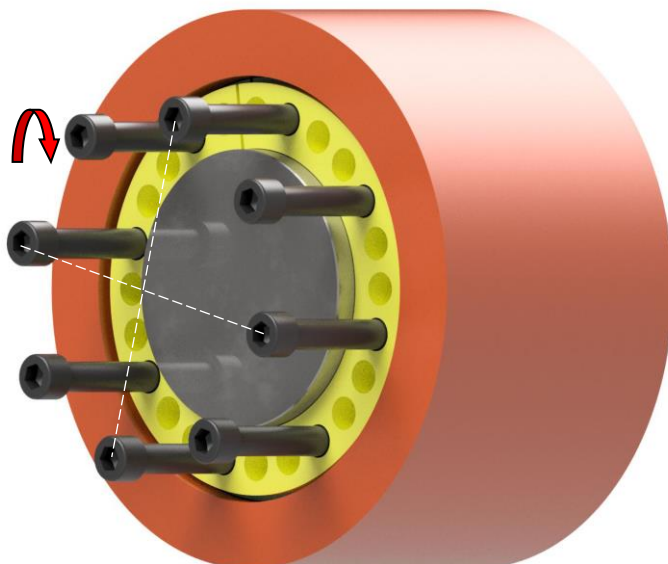

Removal

3.
The front thrust rings slide on the shaft and outer ring.

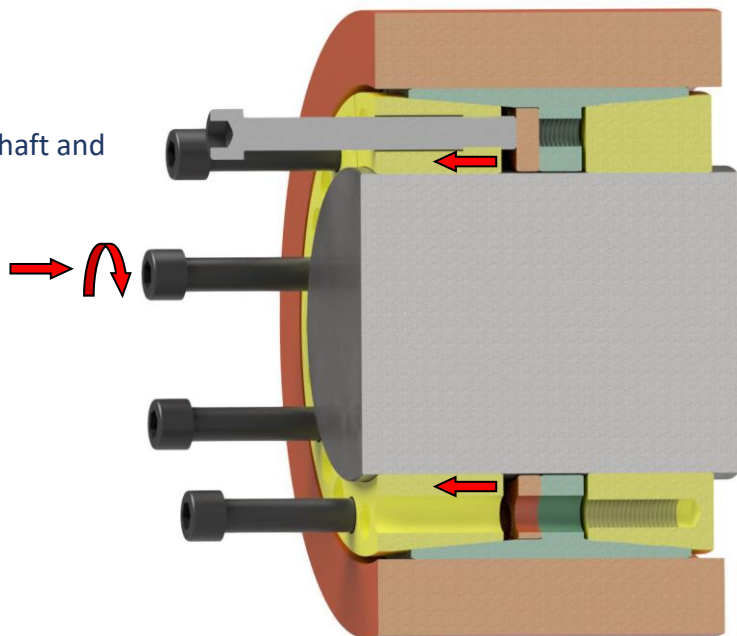

4.
Remove the front thrust ring.

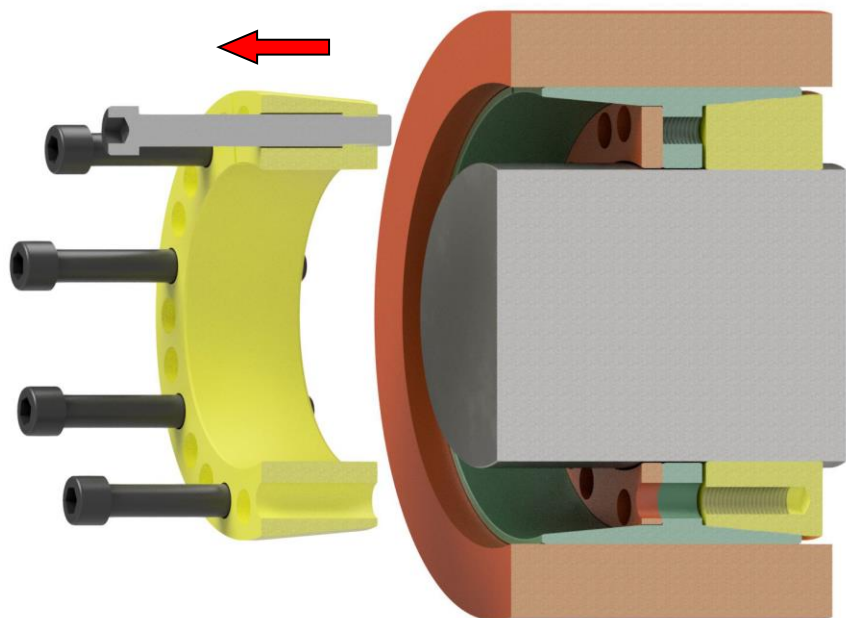

Removal

5.
Remove the intermediate ring.

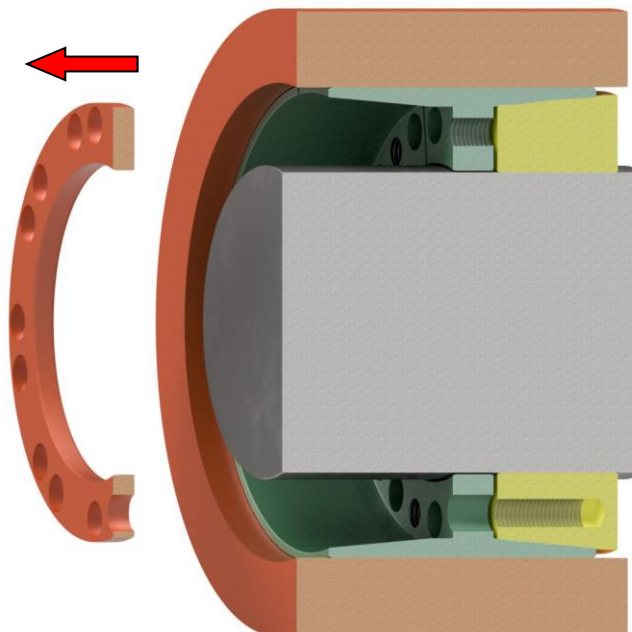

6.
Oil the screws and screw them into the release threads of the rear thrust ring and tighten them crosswise with a torque wrench until the rear thrust ring slides off the shaft and outer ring.

(Grind the release screws flat on the face side before screwing them in)

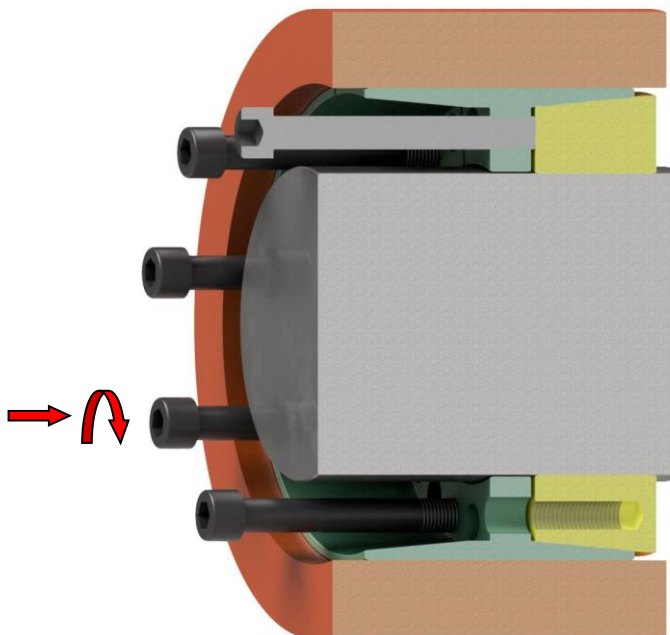

Removal

7.
The rear thrust ring slide on the shaft and outer ring and release the connection.

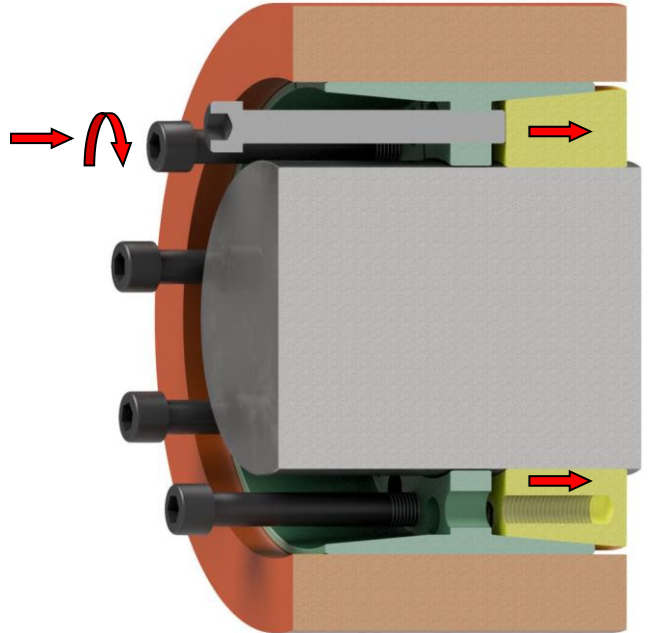

8.
Remove the locking assembly from the space.

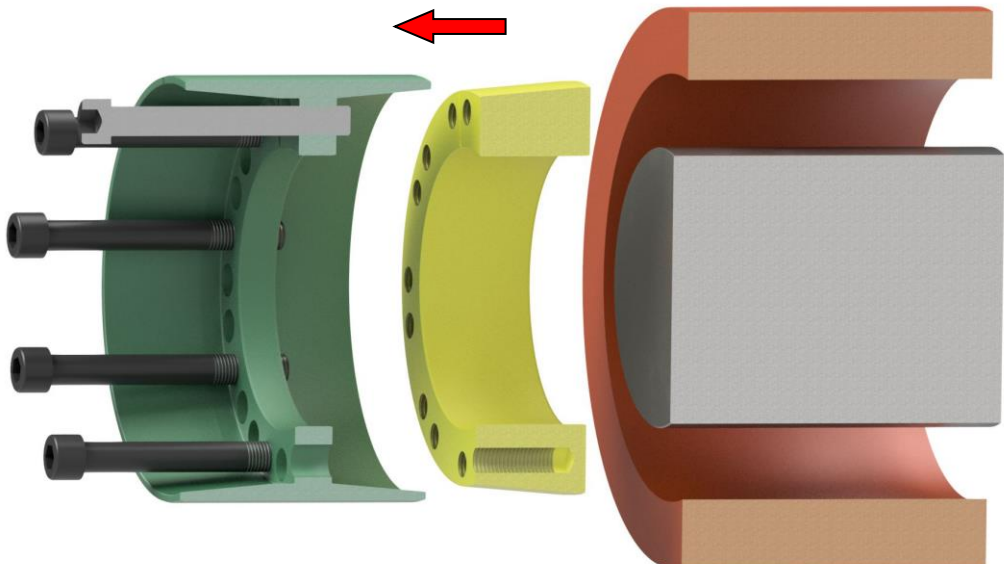

Reusability

Undamaged locking assemblies can be reused.

The screws must be changed after each use!

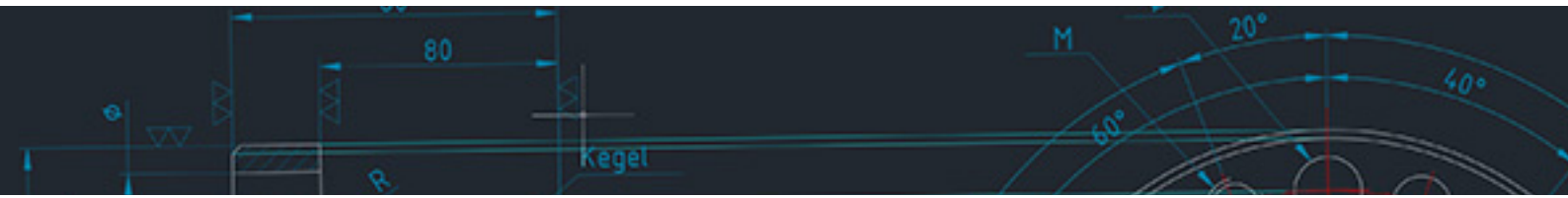

BIKON-Technik GmbH

Hansemannstrasse 11

41468 Neuss • Germany

Tel. ++49 (0) 2131-71889-0

www.bikon.de

E-Mail info@bikon.de