

BIKON 6006
Installation Manual

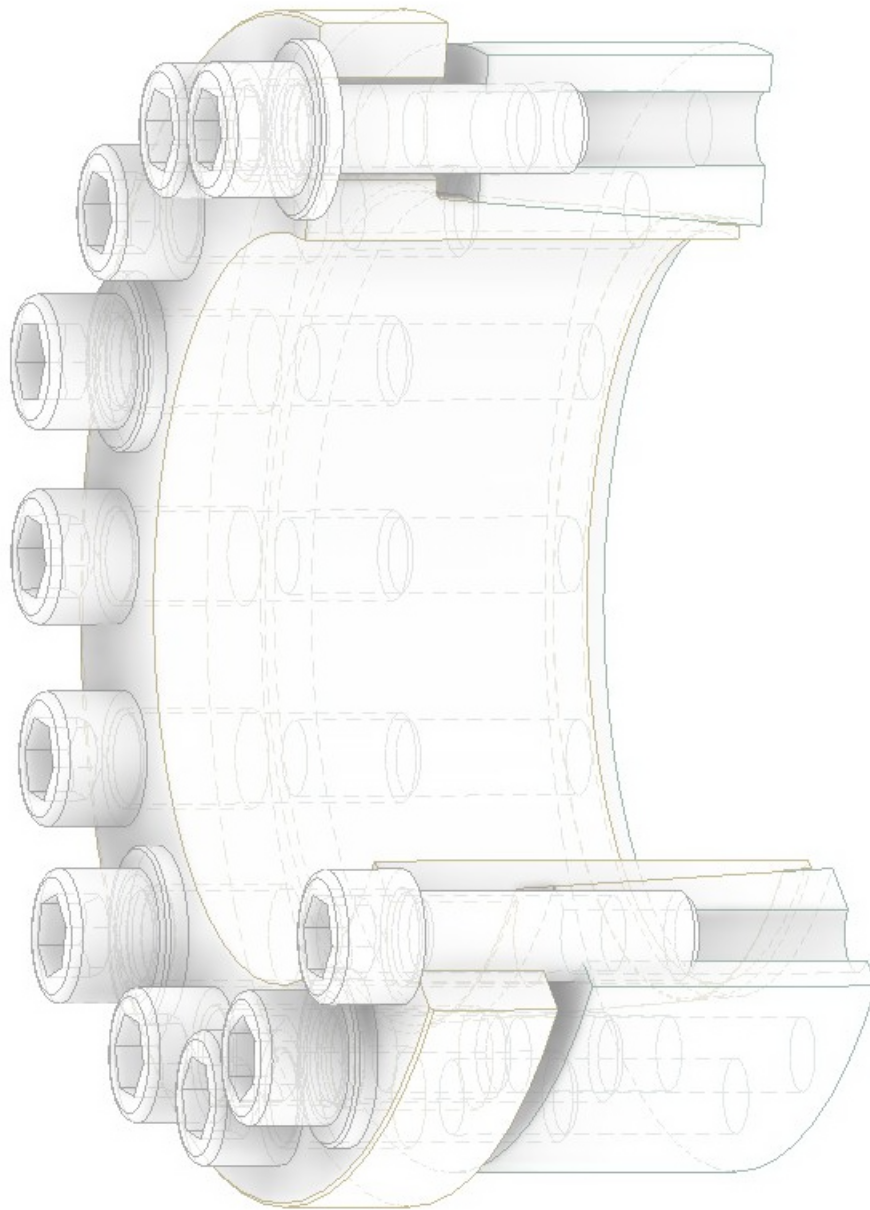

Only available from BIKON-Technik GmbH • 41468 Neuss • Germany

A development of BIKON-Technik GmbH - introduction on global market in year 2008

Index:

We reserve all rights with regard to this technical data and its content. Without our prior written approval it is not allowed to duplicate this technical data or parts of it, nor to grant access to it by third parties or to exploit it otherwise (including extracts) without authority.

All topics and specification dealt with are only valid for original „BIKON“ or „DOBIKON“ products.

We will not accept any liability for damages arising from misinterpretation, application or constructional flaws (regarding equipment wherein our products shall be installed). All information is based upon our knowledge of the current state of the art at the draft date of this technical data.

We refer to our trademark and further intellectual property rights as well as our conditions of sale that shall apply.

April 2023

BIKON 6006

Schematic scetch Darstellung

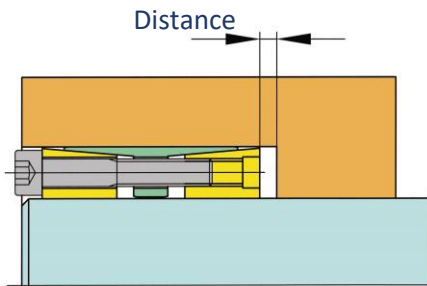

Space - generally

By use of stepped bores the locking assembly should never be pushed to block against the hub. There must be let distance about 2 – 5 mm to the hub to be able to remove the rings from each other. This applies to all BIKON locking assemblies.

Shafts with keyways

BIKON Locking assemblies can be tighten over keyways (according to DIN) on shafts. The function of the locking assembly is not affected.

Keyways in the hub are not allowed !

Space - BIKON 6006

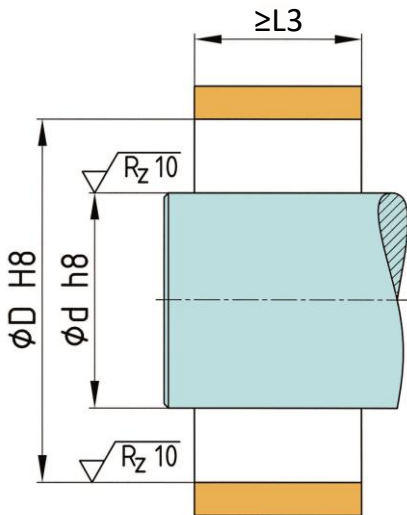

d	D	L3	d	D	L3	d	D	L3
mm	mm	mm	mm	mm	mm	mm	mm	mm
20	47	29	75	115	43	260	325	74
22	47	29	80	120	43	280	355	87
24	50	29	85	125	43	300	375	87
25	50	29	90	130	43	320	405	94
28	55	29	95	135	43	340	425	94
30	55	29	100	150	46	360	445	101
32	60	29	110	160	46	380	465	101
35	60	29	120	170	46	400	485	101
38	65	29	130	185	55	420	505	101
40	65	29	140	195	55	440	525	115
42	80	33	150	205	55	460	546	115
45	80	33	160	215	55	480	565	115
48	85	33	170	230	71	500	585	120
50	85	33	180	240	71	520	605	120
55	90	33	190	250	71	540	625	120
60	95	33	200	260	71	560	645	120
65	100	33	220	285	74	580	665	120
70	110	43	240	305	74	600	685	120

TA – Tightening torque of screws

d	M	TA	d	M	TA	d	M	TA	d	M	TA
mm	-	Nm	mm	-	Nm	mm	-	Nm	mm	-	Nm
20	M6	17	55	M8	41	150	M14	195	380	M20	690
22	M6	17	60	M8	41	160	M14	195	400	M20	690
24	M6	17	65	M8	41	170	M16	320	420	M20	690
25	M6	17	70	M10	83	180	M16	320	440	M20	690
28	M6	17	75	M10	83	190	M16	320	460	M20	690
30	M6	17	80	M10	83	200	M16	320	480	M20	690
32	M6	17	85	M10	83	220	M16	320	500	M20	690
35	M6	17	90	M10	83	240	M16	355	520	M20	690
38	M6	17	95	M10	83	260	M16	355	540	M20	690
40	M6	17	100	M12	145	280	M18	485	560	M20	690
42	M8	41	110	M12	145	300	M18	485	580	M20	690
45	M8	41	120	M12	145	320	M20	690	600	M20	690
48	M8	41	130	M14	195	340	M20	690			
50	M8	41	140	M14	195	360	M20	690			

Installation

1. BIKON locking assemblies are delivered ready for installation and oiled. The screws have been unscrewed a few threads.

Make sure that the rings fit loosely on top of each other (self-locking cone).

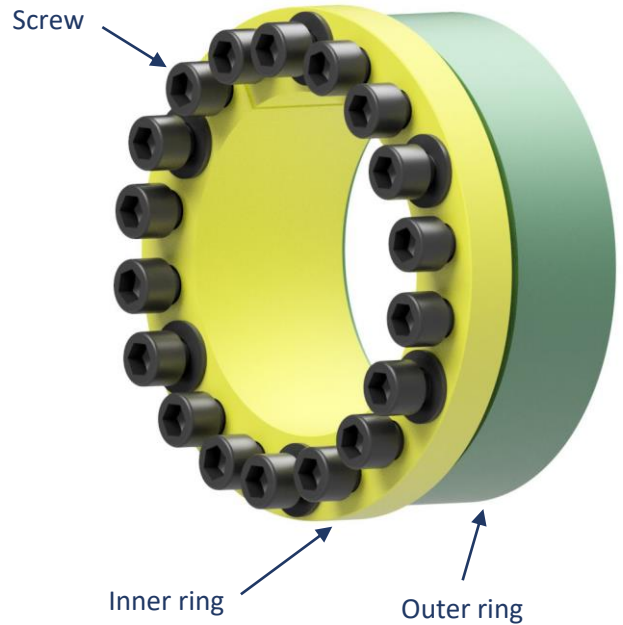

2. Oil the shaft and hub and push the locking assembly into the installation space.

Do not use molybdenum disulfide (MoS₂), assembly paste or grease!

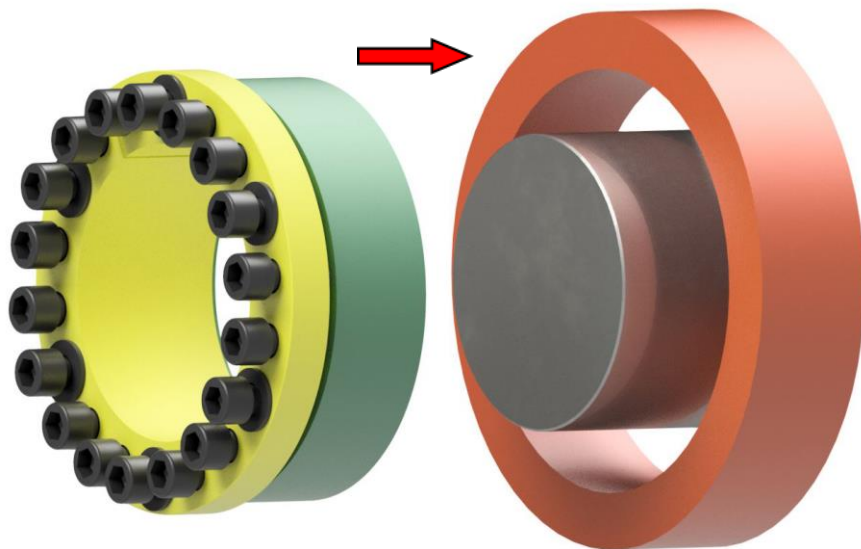

Installation

- 3.**
The locking assembly must sit flush with the hub.

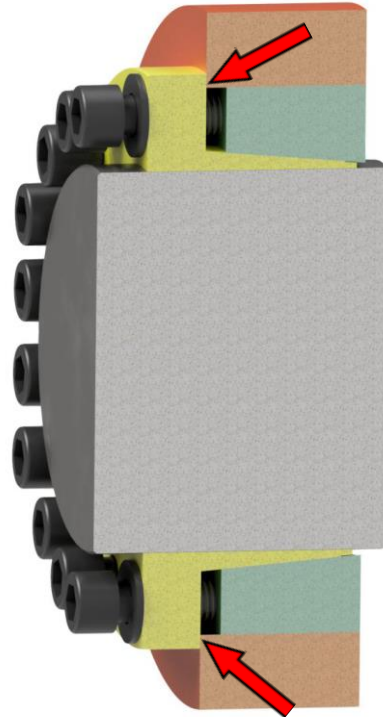

- 4.**
Tighten the screws evenly crosswise and in several stages using a torque wrench.

control !

The tightening of the screws and the assembly is complete when no more screws can be tightened with the 100% tightening torque.

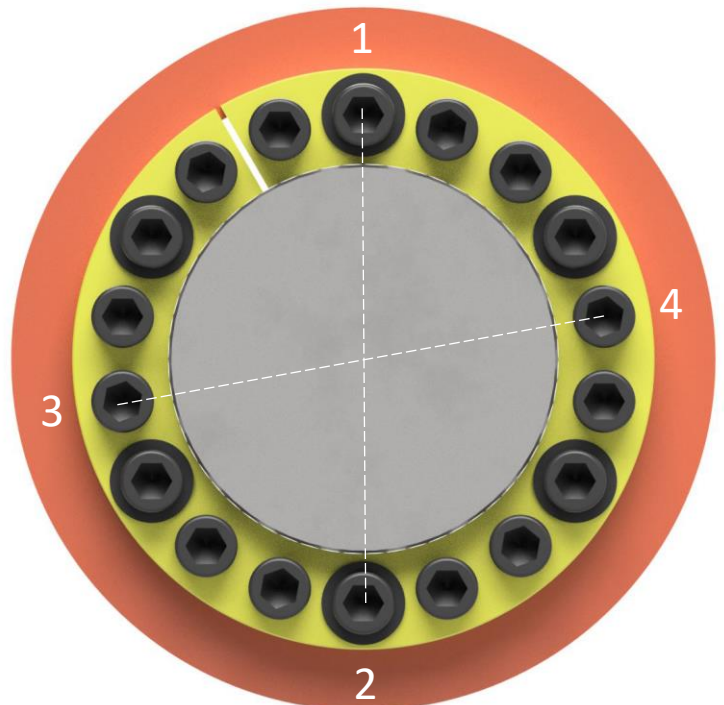

Installation

5.

By tightening the screws, the outer rings slides and tightens the connection. The cone is self-locking and will not loosen by itself if the screws are loosened if it is operated properly.

The hub does not move in the axial direction during assembly.

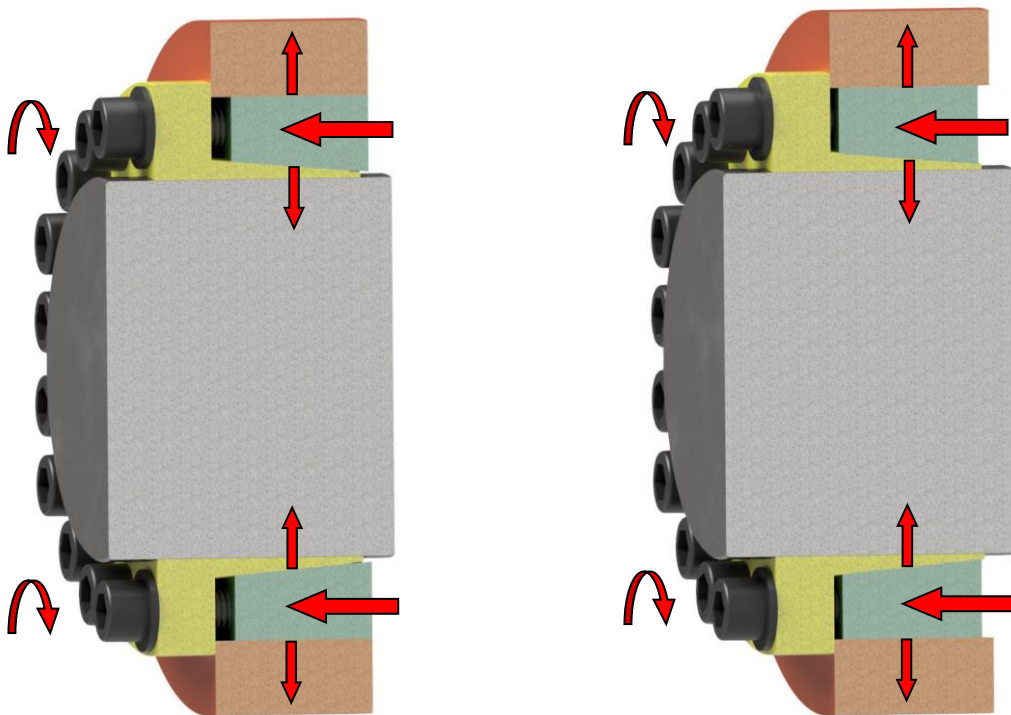

The locking assembly is maintenance-free and the screws do not have to be tightened after a certain period of operation.

Removal

1.
Loosen and unscrew all screws with washers.
The release threads become visible.

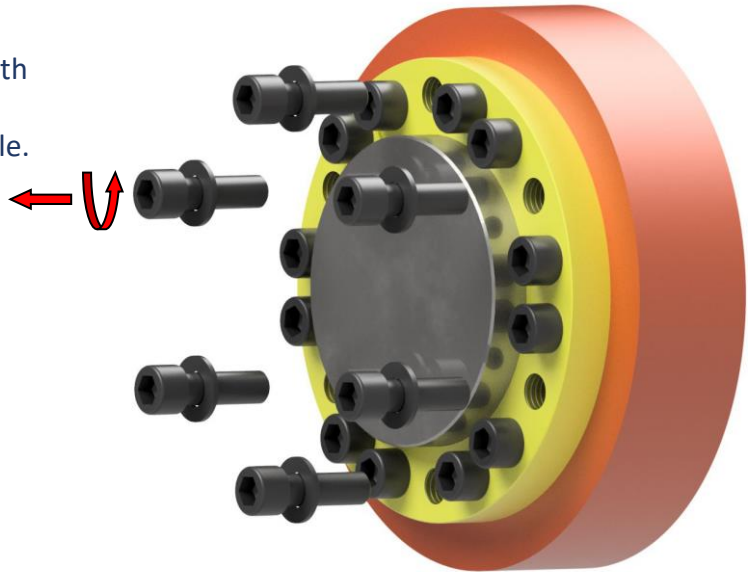

2.
Loosen the remaining screws and
unscrew them a few turns.

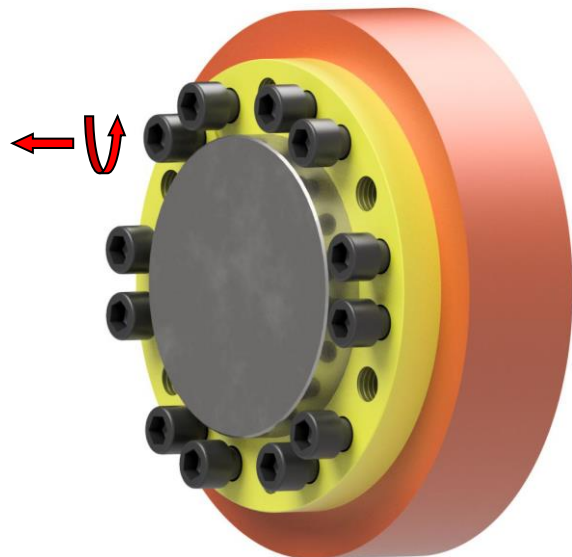

Removal

3.
Place the removing ring on the screw heads

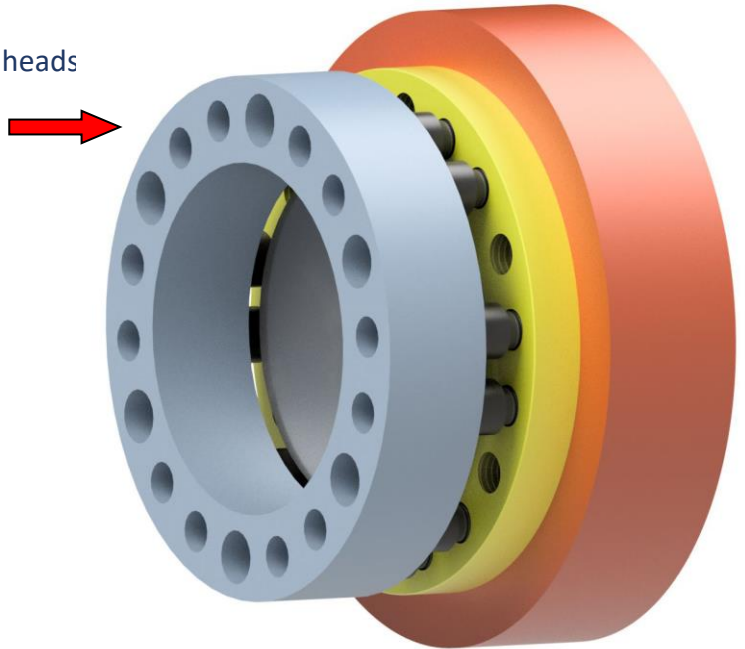

4.
Screw the screws through the removing ring into the release threads and tighten crosswise using a torque wrench.

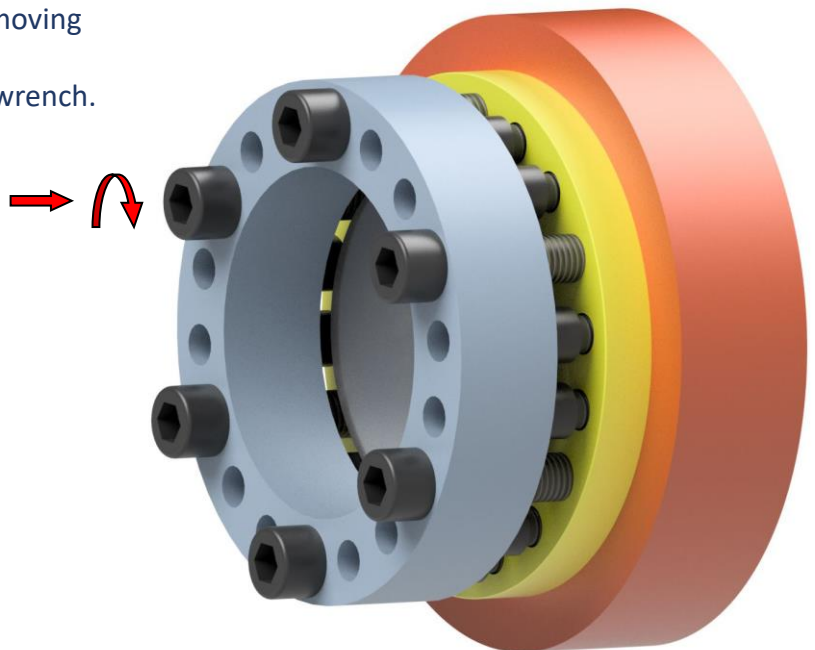

Removal

5.
The thrust ring is pressed off via the screws and thus released.

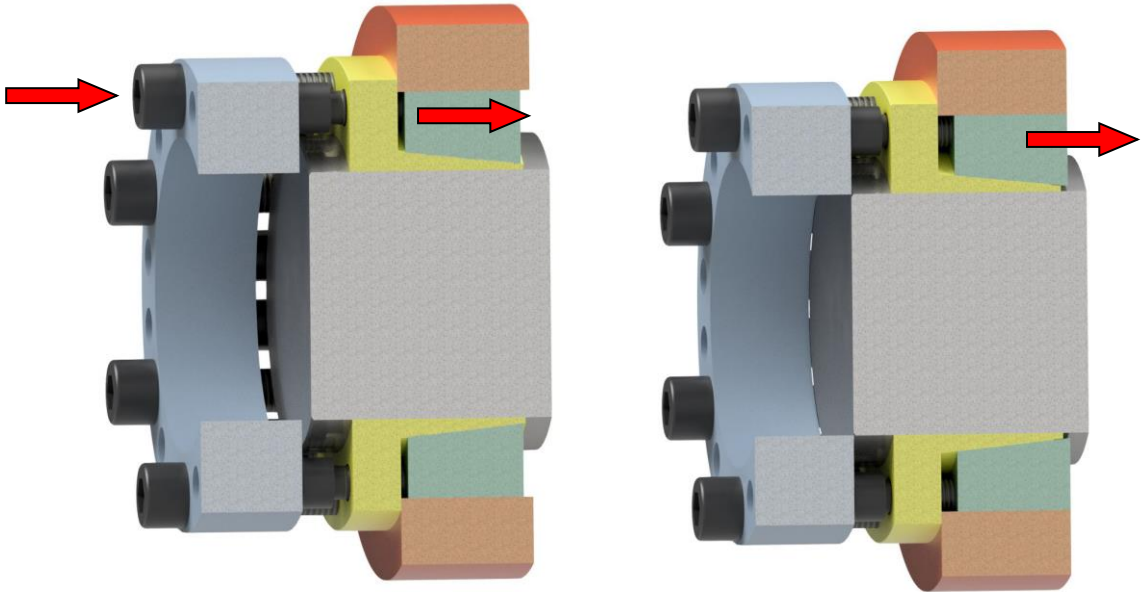

Löseringe auf Anfrage

6.
Remove the locking assembly from the space.

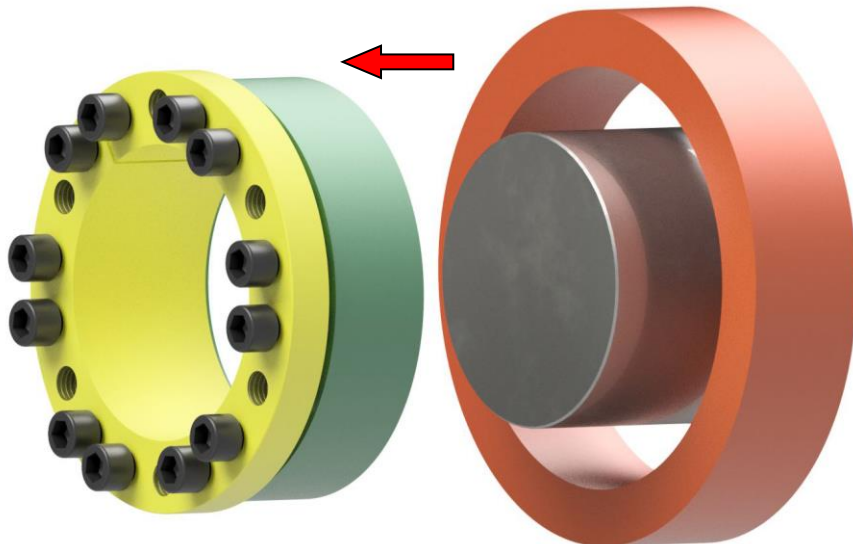

Reusability

Undamaged locking assemblies can be reused.

The screws must be changed after each use!

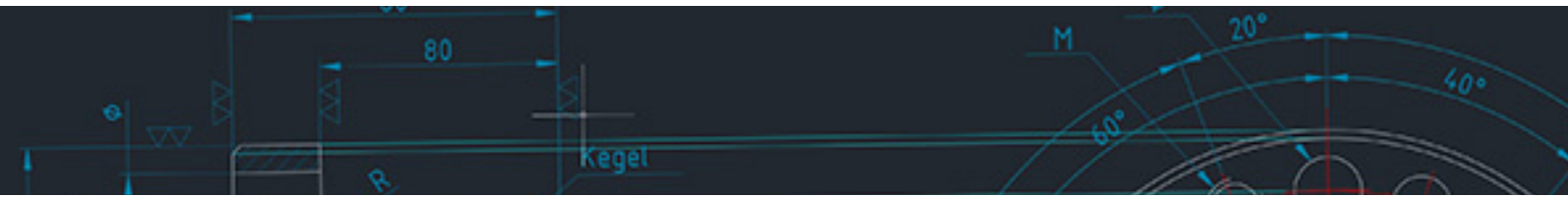

BIKON-Technik GmbH

Hansemannstrasse 11

41468 Neuss • Germany

Tel. ++49 (0) 2131-71889-0

www.bikon.de

E-Mail info@bikon.de