

**BIKON 4000.v** M  
nickel-plated  
*Installation Manual*

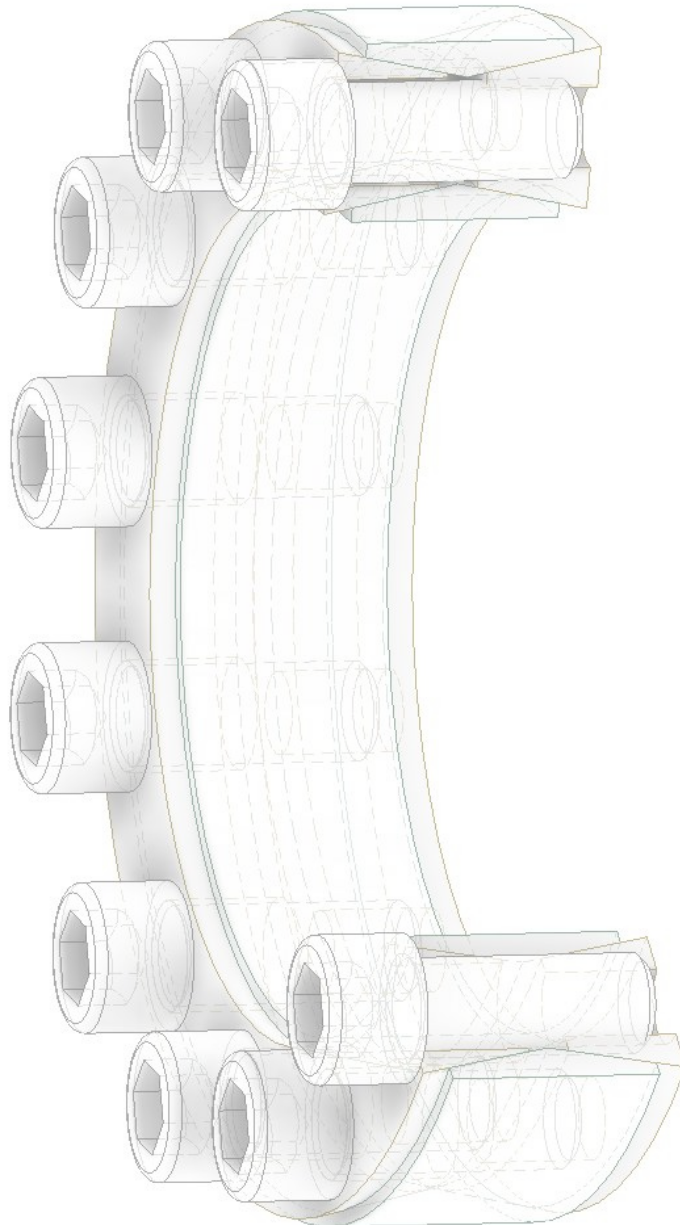

NOtly available from BIKON-Technik GmbH • 41468 Neuss • Germany

## Index:

We reserve all rights with regard to this technical data and its content. Without our prior written approval it is not allowed to duplicate this technical data or parts of it, nor to grant access to it by third parties or to exploit it otherwise (including extracts) without authority.

All topics and specification dealt with are only valid for original „BIKON“ or „DOBIKON“ products.

We will not accept any liability for damages arising from misinterpretation, application or constructional flaws (regarding equipment wherein our products shall be installed). All information is based upon our knowledge of the current state of the art at the draft date of this technical data.

We refer to our trademark and further intellectual property rights as well as our conditions of sale that shall apply.

April 2023

# BIKON 4000.v – nickel plated

Schematic scetch

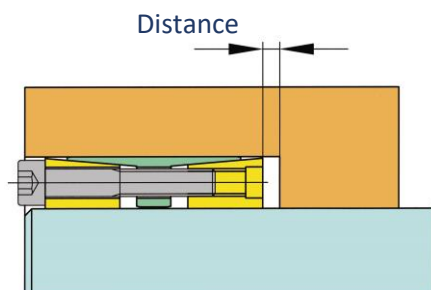

## Space - generally

By use of stepped bores the locking assembly should never be pushed to block against the hub. There must be let distance about 2 – 5 mm to the hub to be able to remove the rings from each other. This applies to all BIKON locking assemblies.

## Shafts with keyways

BIKON Locking assemblies can be tighten over keyways (according to DIN) on shafts. The function of the locking assembly is not affected.

**Keyways in the hub are not allowed !**

## Space - BIKON 4000.v

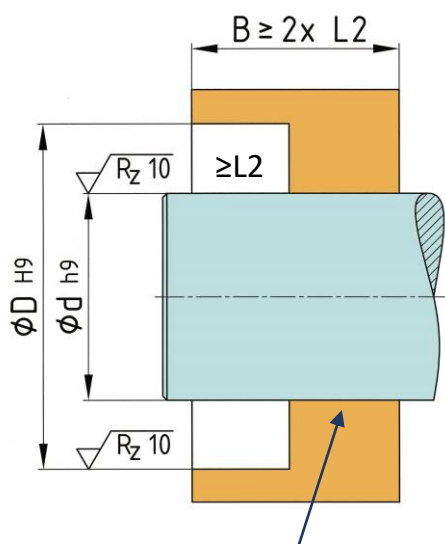

BIKON 4000 is not self-centering and always requires pre-centering.

d	D	L2	d	D	L2	d	D	L2
mm	mm	mm	mm	mm	mm	mm	mm	mm
20	47	20	70	110	28	200	260	52
22	47	20	75	115	28	220	285	56
24	50	20	80	120	28	240	305	56
25	50	20	85	125	28	260	325	56
28	55	20	90	130	28	280	355	66
30	55	20	95	135	28	300	375	66
32	60	20	100	145	33	320	405	78
35	60	20	110	155	33	340	425	78
38	65	20	120	165	33	360	455	90
40	65	20	130	180	38	380	475	90
42	75	24	140	190	38	400	495	90
45	75	24	150	200	38	420	515	90
48	80	24	160	210	38	440	545	102
50	80	24	170	225	44	460	565	102
55	85	24	180	235	44	480	585	102
60	90	24	190	250	52	500	605	102
65	95	24						

## TA – Tightening torque of screws

d	M	TA	d	M	TA	d	M	TA	d	M	TA
mm	-	Nm	mm	-	Nm	mm	-	Nm	mm	-	Nm
20	M6	14	50	M8	35	120	M12	125	280	M18	405
22	M6	14	55	M8	35	130	M12	125	300	M18	405
24	M6	14	60	M8	35	140	M12	125	320	M20	580
25	M6	14	65	M8	35	150	M12	125	340	M20	580
28	M6	14	70	M10	70	160	M12	125	360	M22	780
30	M6	14	75	M10	70	170	M14	190	380	M22	780
32	M6	14	80	M10	70	180	M14	190	400	M22	780
35	M6	14	85	M10	70	190	M14	190	420	M22	780
38	M6	14	90	M10	70	200	M14	190	440	M24	1 000
40	M6	14	95	M10	70	220	M16	295	460	M24	1 000
42	M8	35	100	M12	125	240	M16	295	480	M24	1 000
45	M8	35	110	M12	125	260	M16	295	500	M24	1 000
48	M8	35									

# BIKON 4000.v – nickel plated

## Installation

### 1.

BIKON locking assemblies are delivered ready for installation and oiled. The screws have been unscrewed a few threads.

Make sure that the rings fit loosely on top of each other (no self-locking cones).

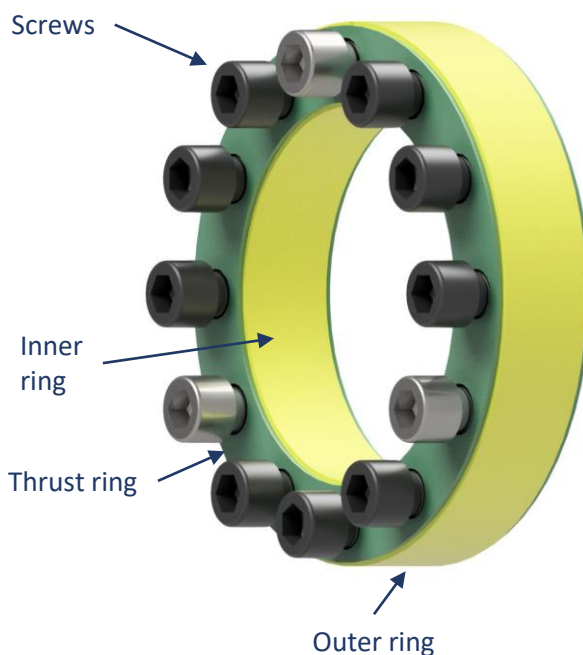

### 2.

Oil the shaft and hub and push the locking assembly into the installation space.

Do not use molybdenum disulfide (MoS<sub>2</sub>), assembly paste or grease!

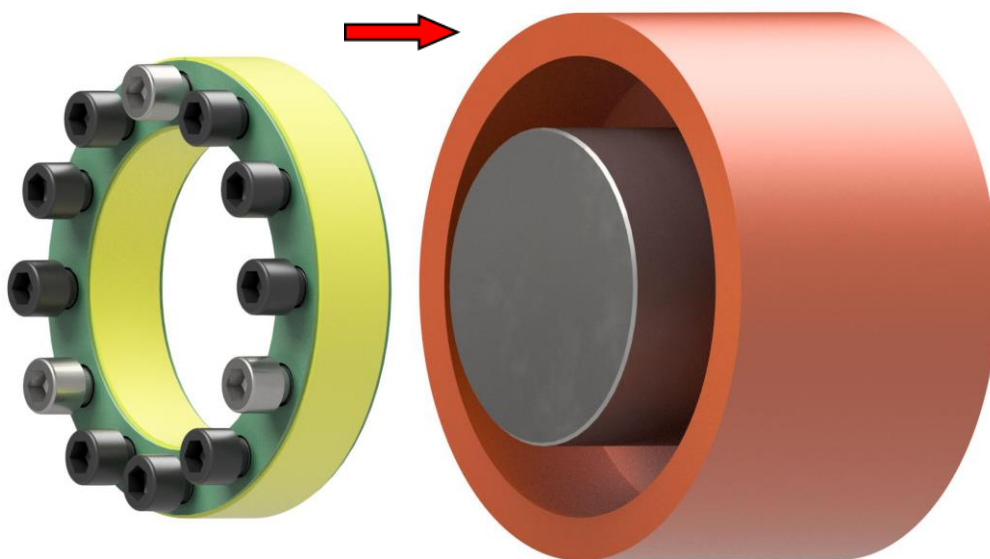

# BIKON 4000.v – nickel plated

## Installation

**3.**

The locking assembly must sit min. flush with the hub.

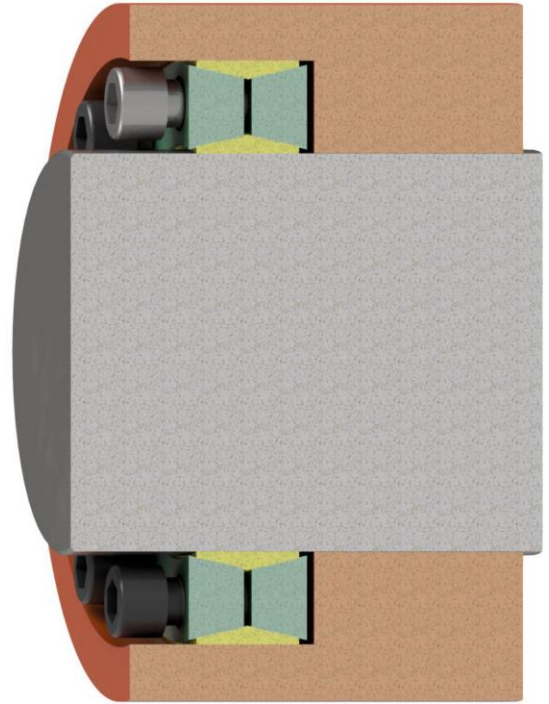

**4.**

Tighten the screws evenly crosswise and in several stages using a torque wrench.

### **control !**

The tightening of the screws and the assembly is complete when no more screws can be tightened with the 100% tightening torque.

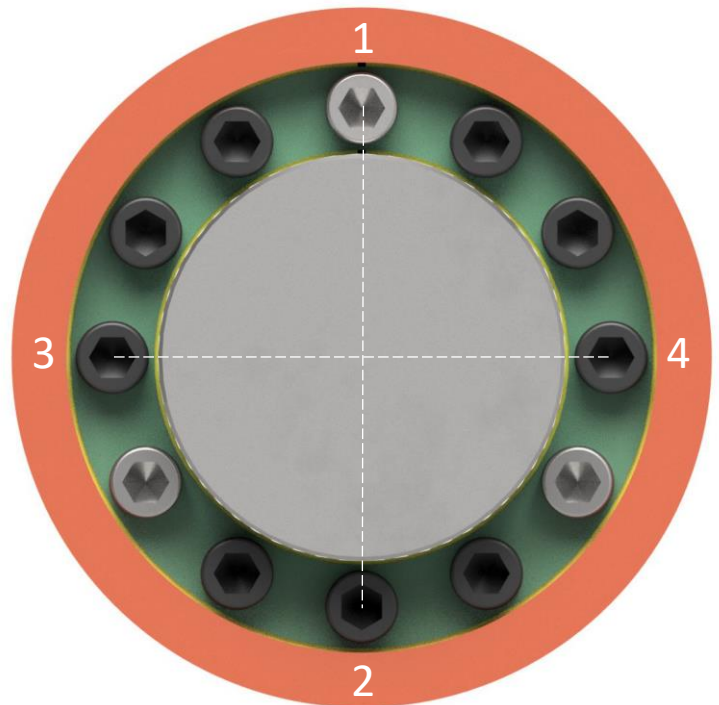

# BIKON 4000.v – nickel plated

## Installation

5.

By tightening the screws, the thrust rings slides and tightens the connection. The cones are not self-locking

The hub moves in the axial direction with the outer ring!

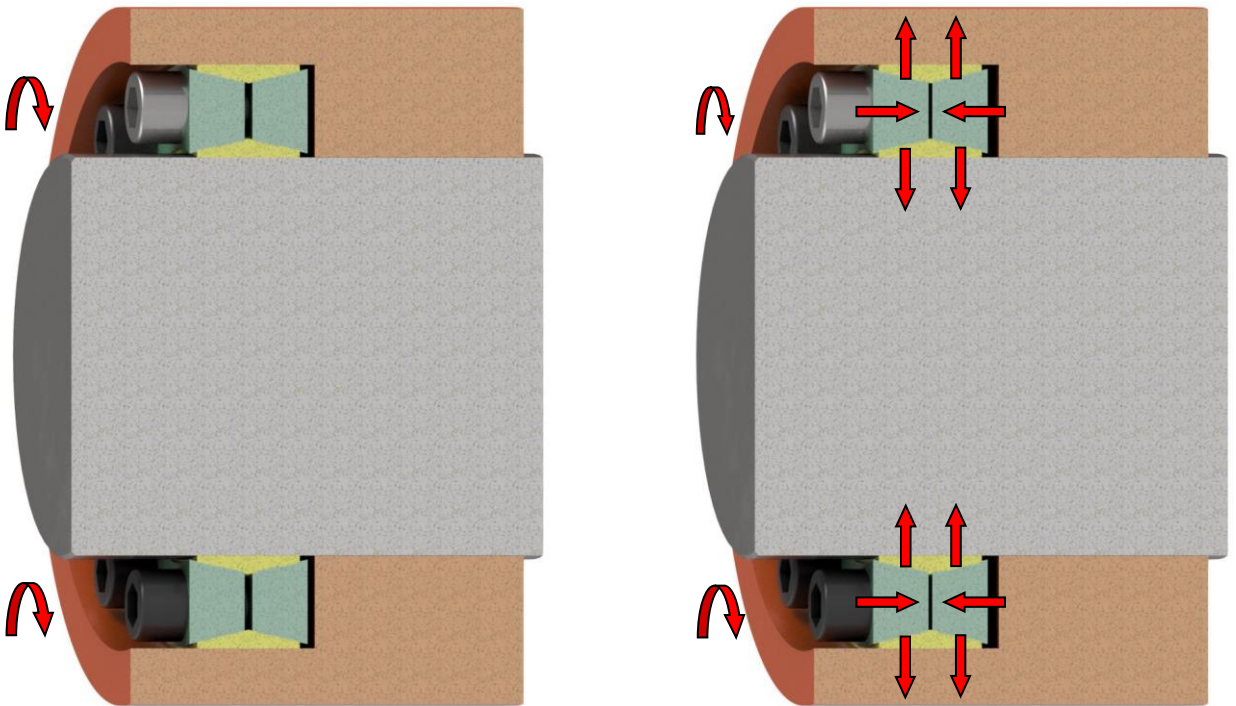

The locking assembly is maintenance-free.

# BIKON 4000.v – nickel plated

## Removal

1. Loosen all screws evenly and crosswise.  
Several turns are necessary until all screws are loosened.  
Do not unscrew the screws completely.

The cones are not self-locking and the thrust rings loosen when the screws are released.

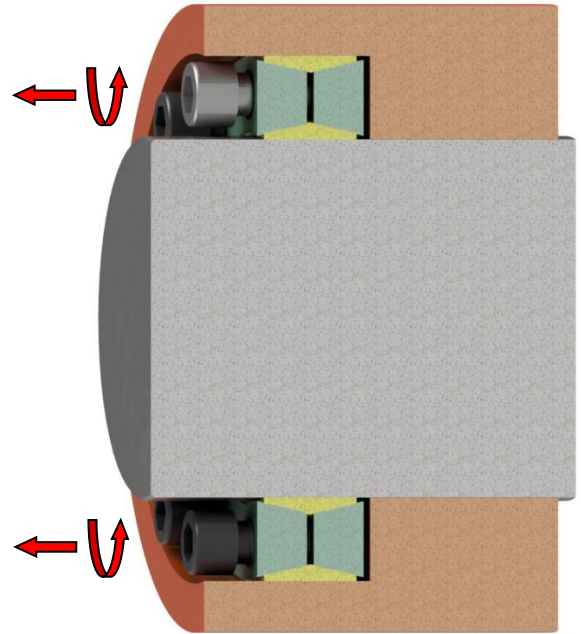

2. Remove the locking assembly from the space.

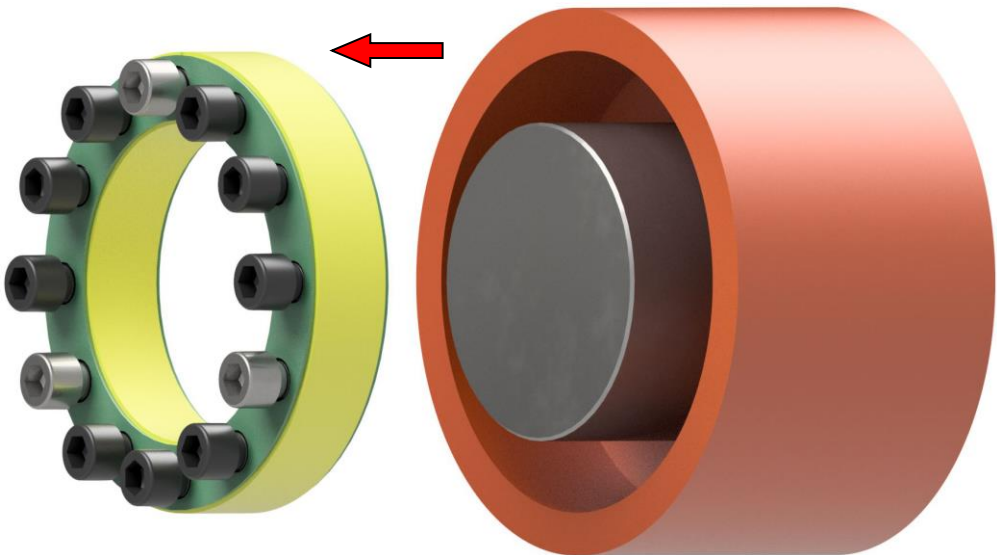

## Reusability

Undamaged locking assemblies can be reused.

**The screws must be changed after each use!**

# BIKON 4000.v – nickel plated

## Removal

3.  
If the locking assembly is blockaded when loosening,  
tap the screws lightly.

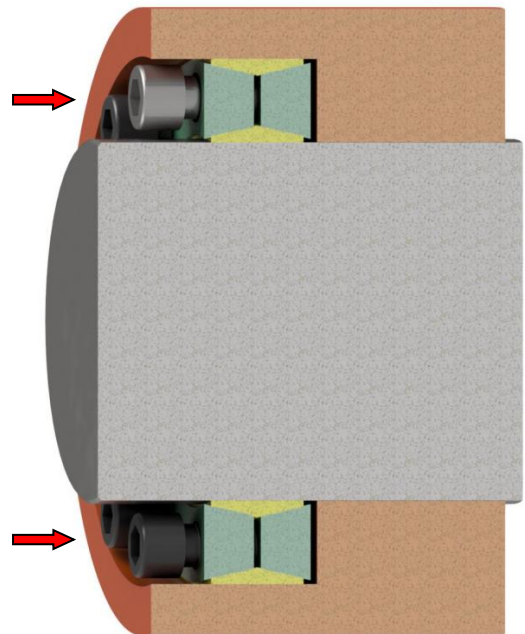

4.  
Unscrew zink-coated screws.

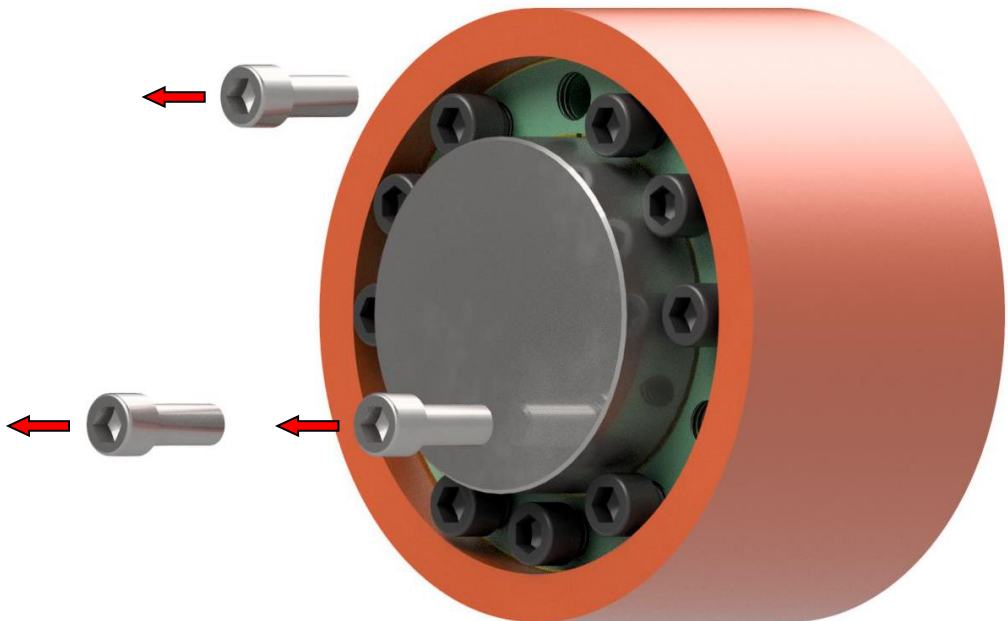



# BIKON 4000.v – nickel plated

## Removal

5. Screw in screws or threaded rod of size and pull out the locking assembly.

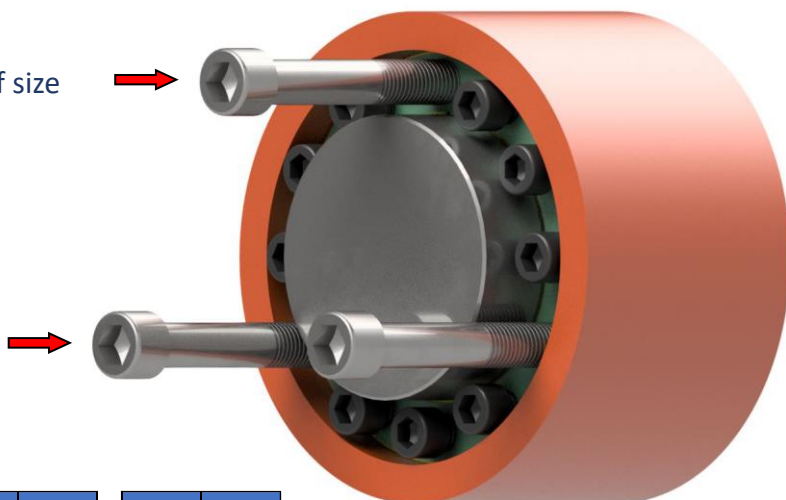

d	da	d	da	d	da	d	da
mm	-	mm	-	mm	-	mm	-
20	M8	50	M10	120	M16	280	M22
22	M8	55	M10	130	M16	300	M22
24	M8	60	M10	140	M16	320	M24
25	M8	65	M10	150	M16	340	M24
28	M8	70	M12	160	M16	360	M27
30	M8	75	M12	170	M18	380	M27
32	M8	80	M12	180	M18	400	M27
35	M8	85	M12	190	M18	420	M27
38	M8	90	M12	200	M18	440	M30
40	M8	95	M12	220	M20	460	M30
42	M10	100	M16	240	M20	480	M30
45	M10	110	M16	260	M20	500	M30
48	M10						

6. Remove the locking assembly from the space.

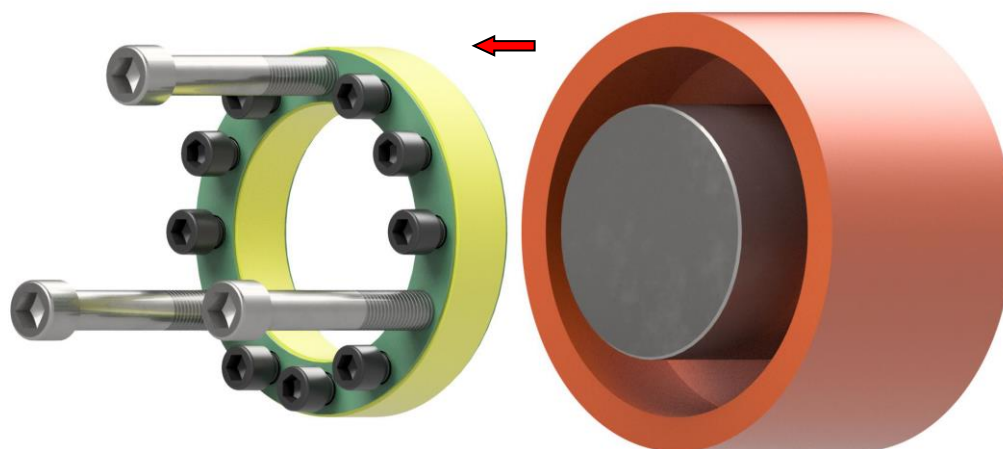

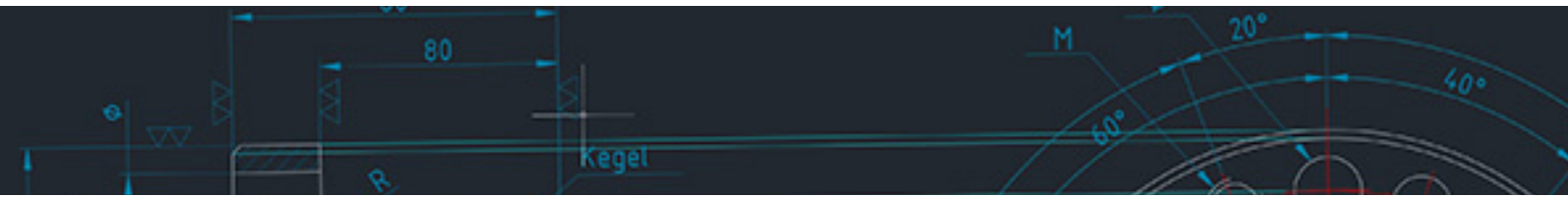

# BIKON-Technik GmbH

Hansemannstrasse 11

41468 Neuss • Germany

Tel. ++49 (0) 2131-71889-0

[www.bikon.de](http://www.bikon.de)

E-Mail [info@bikon.de](mailto:info@bikon.de)