

**BIKON 4000.r**  
stainless  
Installation Manual

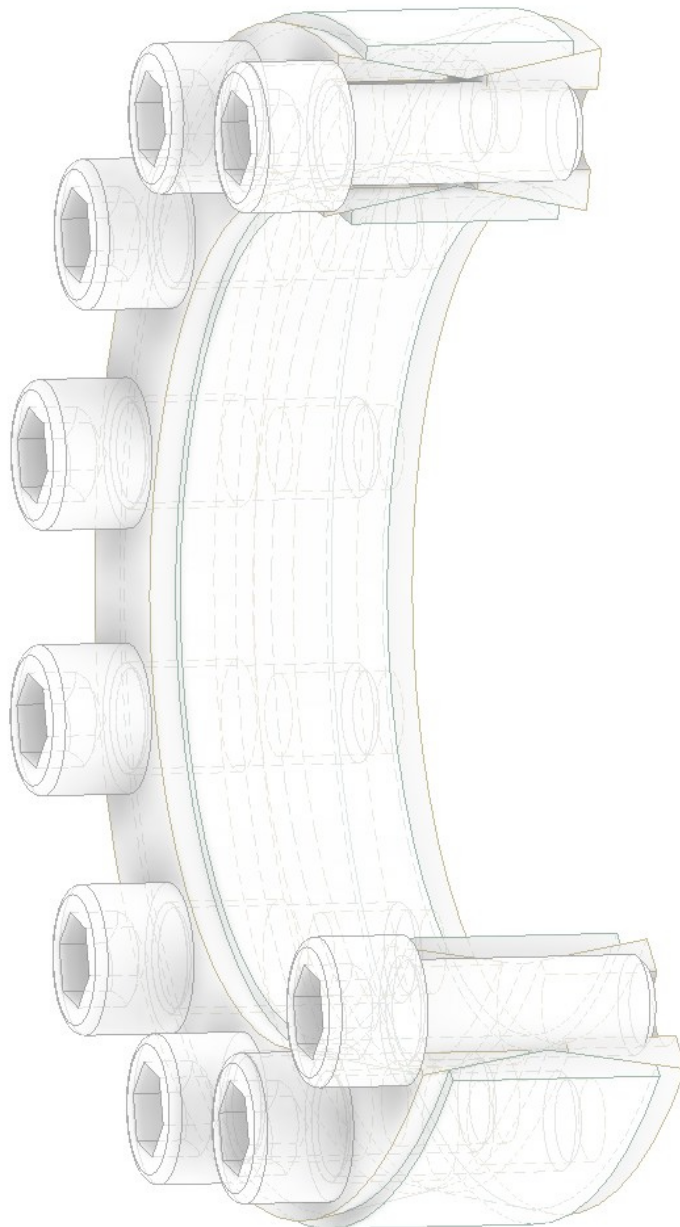

Only available from BIKON-Technik GmbH • 41468 Neuss • Germany

## Index:

We reserve all rights with regard to this technical data and its content. Without our prior written approval it is not allowed to duplicate this technical data or parts of it, nor to grant access to it by third parties or to exploit it otherwise (including extracts) without authority.

All topics and specification dealt with are only valid for original „BIKON“ or „DOBIKON“ products.

We will not accept any liability for damages arising from misinterpretation, application or constructional flaws (regarding equipment wherein our products shall be installed). All information is based upon our knowledge of the current state of the art at the draft date of this technical data.

We refer to our trademark and further intellectual property rights as well as our conditions of sale that shall apply.

April 2023

# BIKON 4000.r - stainless

Schematic sketch

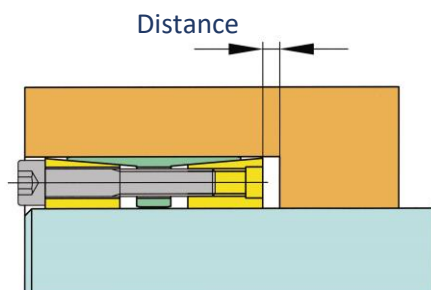

## Space - generally

By use of stepped bores the locking assembly should never be pushed to block against the hub. There must be let distance about 2 – 5 mm to the hub to be able to remove the rings from each other. This applies to all BIKON locking assemblies.

## Shafts with keyways

BIKON Locking assemblies can be tighten over keyways (according to DIN) on shafts. The function of the locking assembly is not affected.

**Keyways in the hub are not allowed !**

## Space - BIKON 4000.r

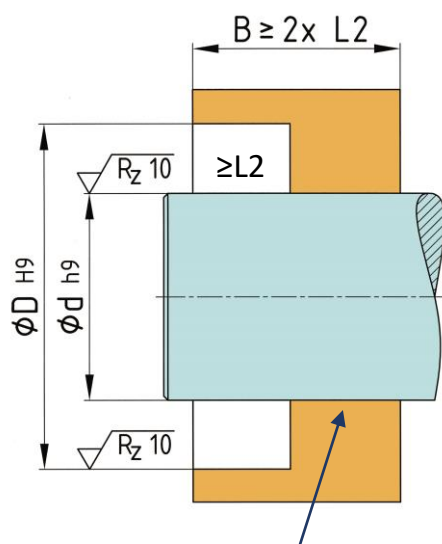

BIKON 4000 is not self-centering and always requires pre-centering.

d	D	L2
mm	mm	mm
20	47	20
22	47	20
24	50	20
25	50	20
28	55	20
30	55	20
32	60	20
35	60	20
38	65	20
40	65	20
42	75	24
45	75	24

d	D	L2
mm	mm	mm
48	80	24
50	80	24
55	85	24
60	90	24
65	95	24
70	110	28
75	115	28
80	120	28
85	125	28
90	130	28
95	135	28

d	D	L2
mm	mm	mm
100	145	33
110	155	33
120	165	33
130	180	38
140	190	38
150	200	38
160	210	38
170	225	44
180	235	44
190	250	52
200	260	52

## TA – Tightening torque of screws

d	M	TA
mm	-	Nm
20	M6	7,3
22	M6	7,3
24	M6	7,3
25	M6	7,3
28	M6	7,3
30	M6	7,3
32	M6	7,3
35	M6	7,3
38	M6	7,3
40	M6	7,3
42	M8	17,5
45	M8	17,5

d	M	TA
mm	-	Nm
48	M8	17,5
50	M8	17,5
55	M8	17,5
60	M8	17,5
65	M8	17,5
70	M10	35,2
75	M10	35,2
80	M10	35,2
85	M10	35,2
90	M10	35,2
95	M10	35,2

d	M	TA
mm	-	Nm
100	M12	60,3
110	M12	60,3
120	M12	60,3
130	M12	60,3
140	M12	60,3
150	M12	60,3
160	M12	60,3
170	M14	95,8
180	M14	95,8
190	M14	95,8
200	M14	95,8

## Installation

### 1.

BIKON locking assemblies are delivered ready for installation and oiled. The screws have been unscrewed a few threads.

Make sure that the rings fit loosely on top of each other (no self-locking cones).

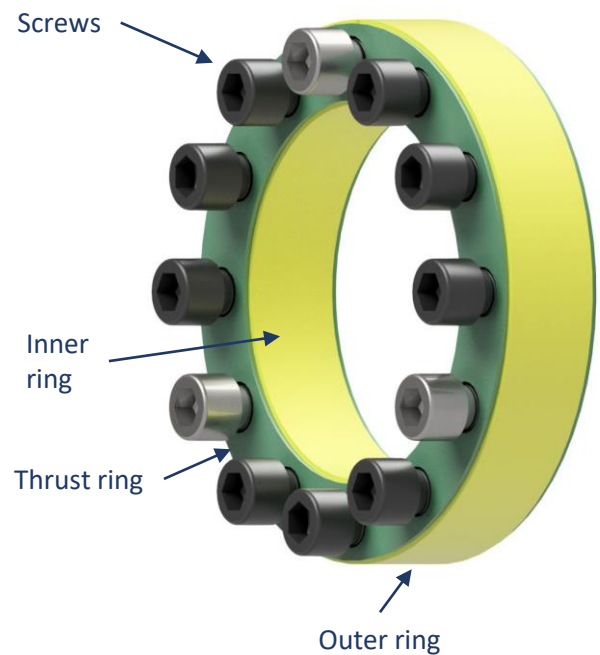

### 2.

Oil the shaft and hub and push the locking assembly into the installation space.

Do not use molybdenum disulfide (MoS<sub>2</sub>), assembly paste or grease!

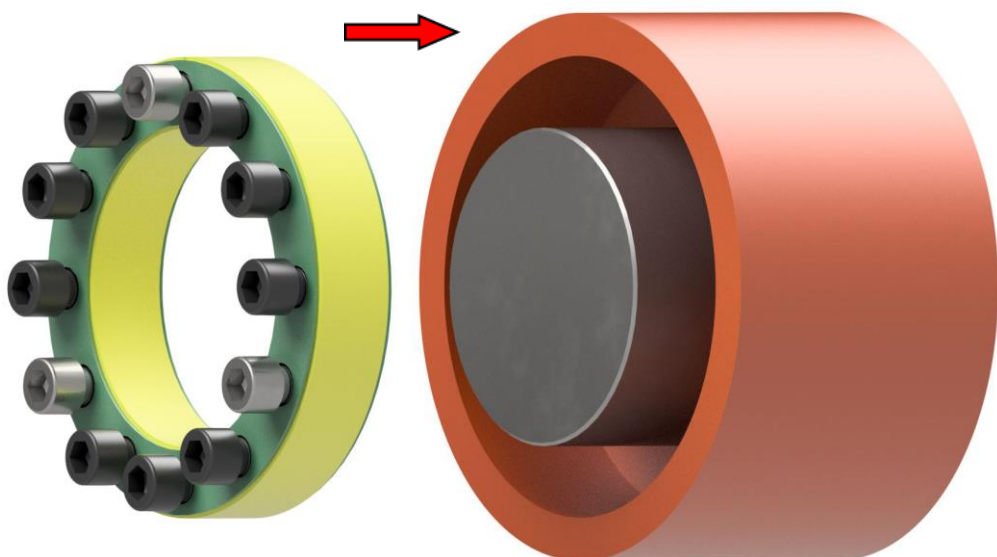

# BIKON 4000.r - stainless

## Installation

**3.**

The locking assembly must sit min. flush with the hub.

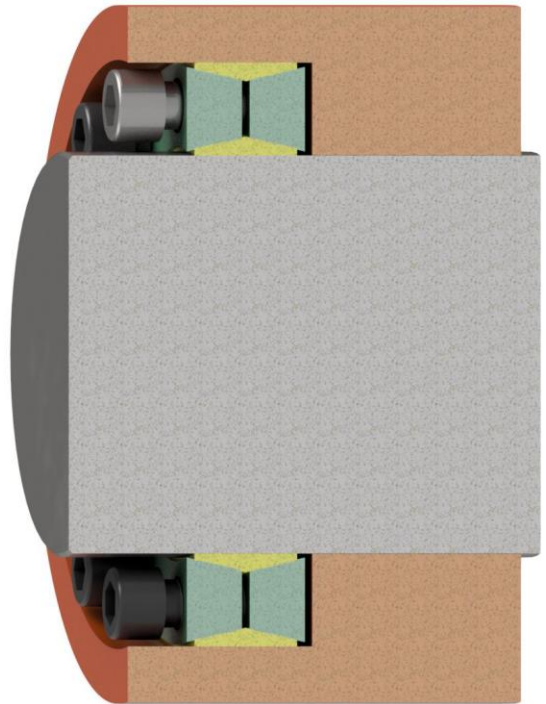

**4.**

Tighten the screws evenly crosswise and in several stages using a torque wrench.

### control !

The tightening of the screws and the assembly is complete when no more screws can be tightened with the 100% tightening torque.

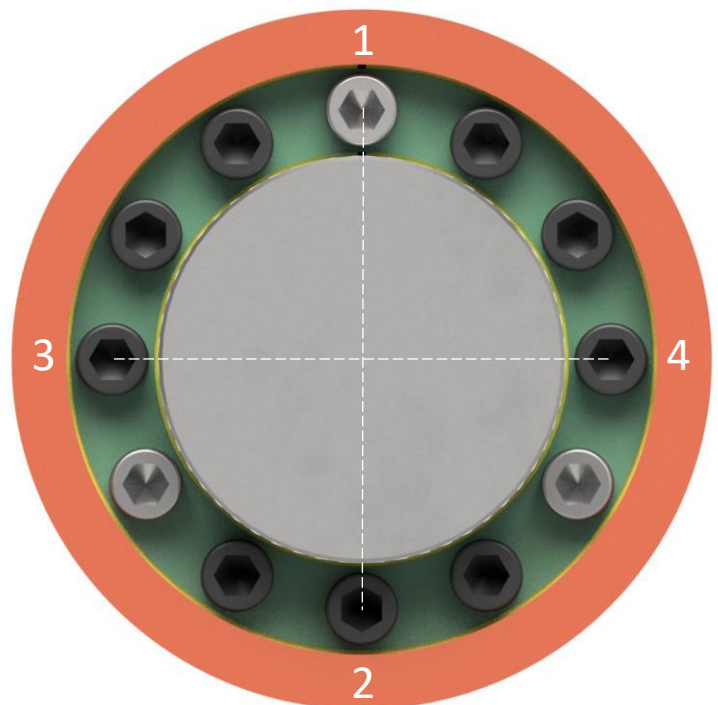

# BIKON 4000.r - stainless

## Installation

5.

By tightening the screws, the thrust rings slides and tightens the connection. The cones are not self-locking

The hub moves in the axial direction with the outer ring!

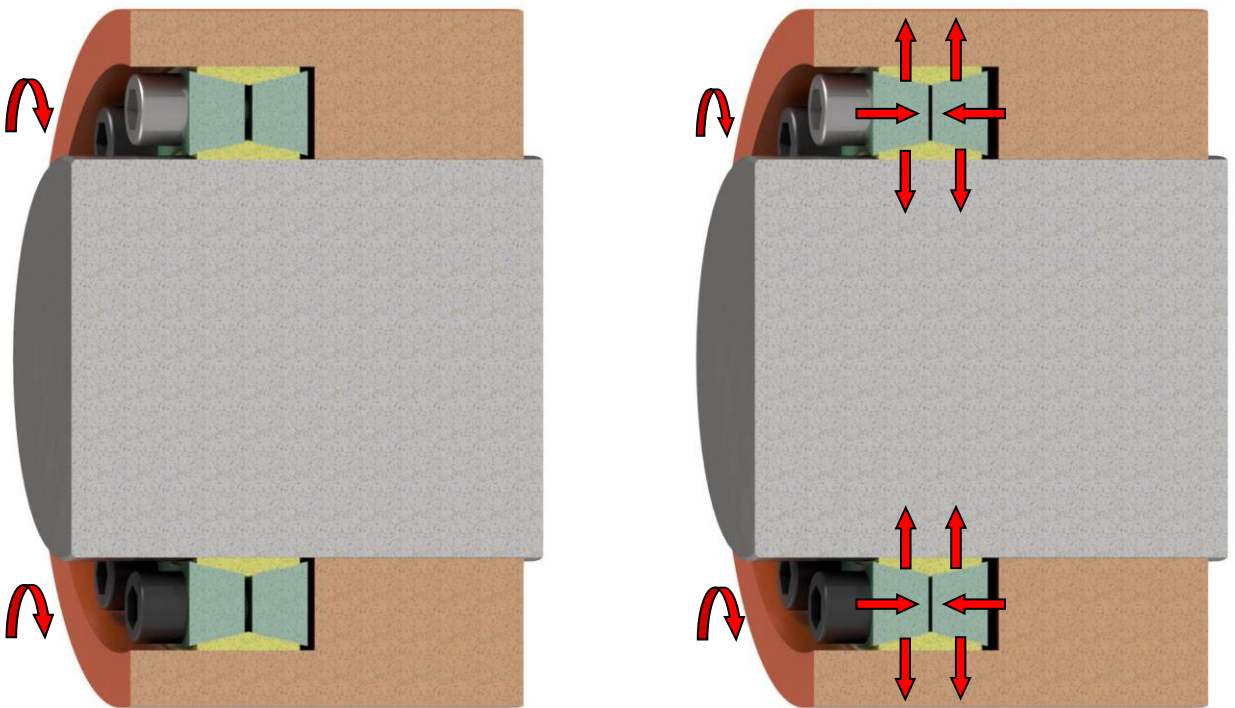

The locking assembly is maintenance-free.

# BIKON 4000.r - stainless

## Removal

1. Loosen all screws evenly and crosswise. Several turns are necessary until all screws are loosened. Do not unscrew the screws completely.

The cones are not self-locking and the thrust rings loosen when the screws are released.

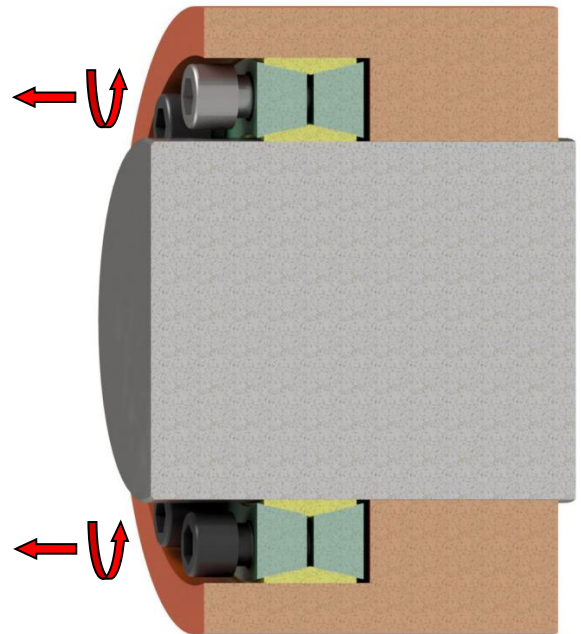

2. Remove the locking assembly from the space.

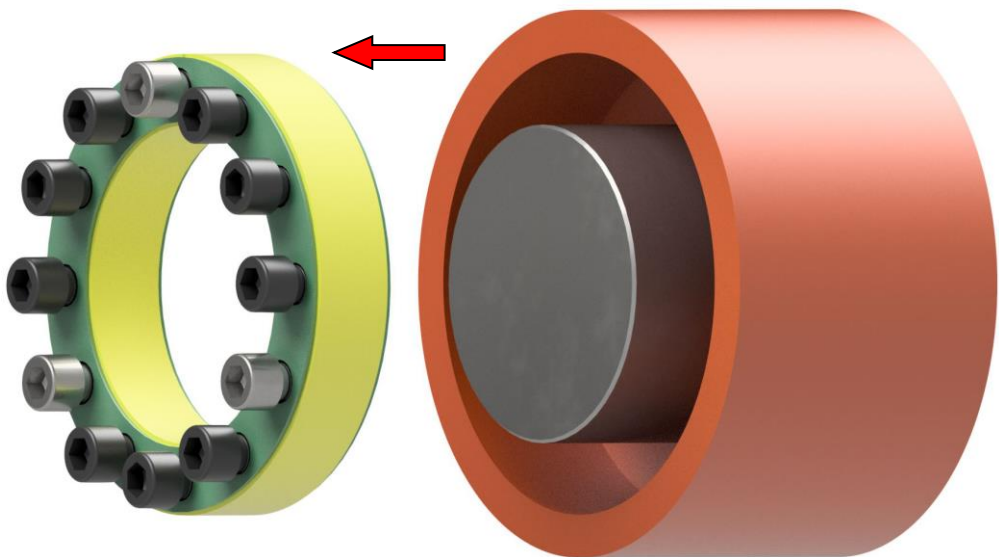

## Reusability

Undamaged locking assemblies can be reused.

**The screws must be changed after each use!**

## Removal

3.  
If the locking assembly is blockaded when loosening,  
tap the screws lightly.

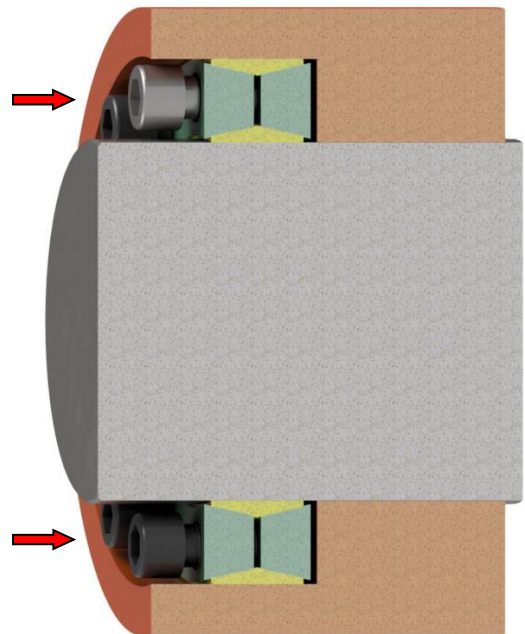

4.  
Unscrew zink-coated screws.

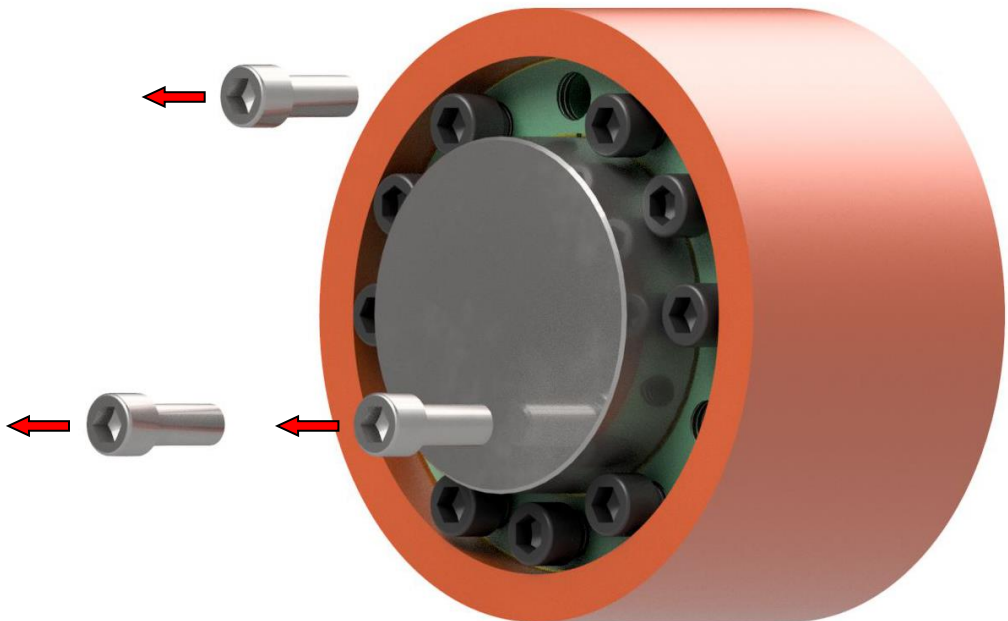



# BIKON 4000.r - stainless

## Removal

5. Screw in screws or threaded rod of size and pull out the locking assembly.

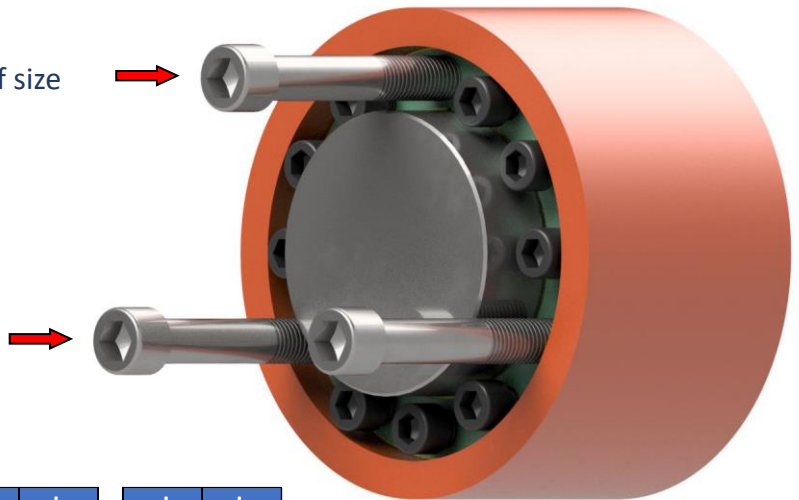

d	da	d	da	d	da	d	da
mm	-	mm	-	mm	-	mm	-
20	M8	50	M10	120	M16	280	M22
22	M8	55	M10	130	M16	300	M22
24	M8	60	M10	140	M16	320	M24
25	M8	65	M10	150	M16	340	M24
28	M8	70	M12	160	M16	360	M27
30	M8	75	M12	170	M18	380	M27
32	M8	80	M12	180	M18	400	M27
35	M8	85	M12	190	M18	420	M27
38	M8	90	M12	200	M18	440	M30
40	M8	95	M12	220	M20	460	M30
42	M10	100	M16	240	M20	480	M30
45	M10	110	M16	260	M20	500	M30
48	M10						

6. Remove the locking assembly from the space.

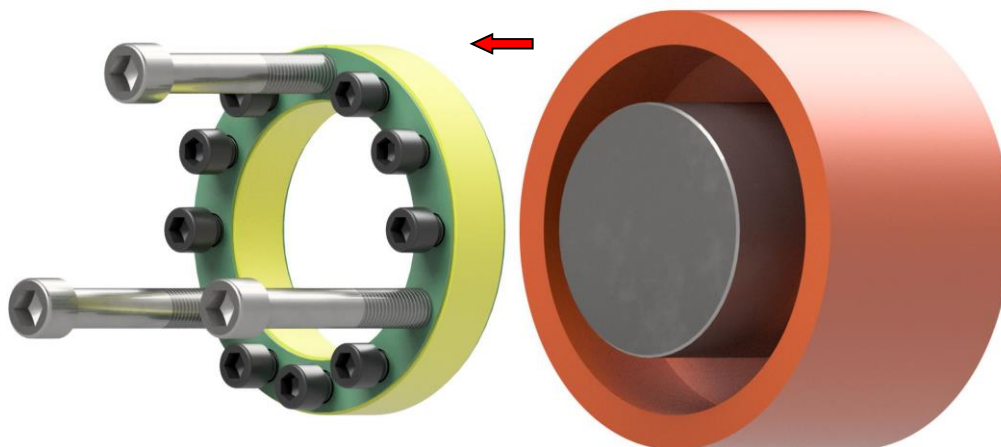

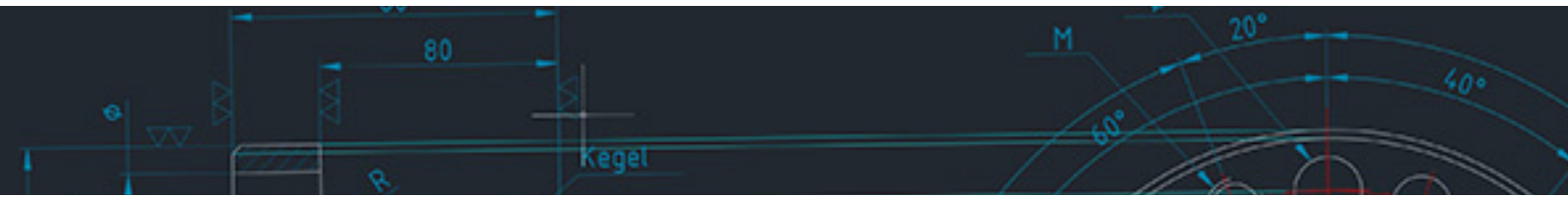

## **BIKON-Technik GmbH**

Hansemannstrasse 11

41468 Neuss • Germany

Tel. ++49 (0) 2131-71889-0

[www.bikon.de](http://www.bikon.de)

E-Mail [info@bikon.de](mailto:info@bikon.de)