

**BIKON 1011**  
Installation Manual

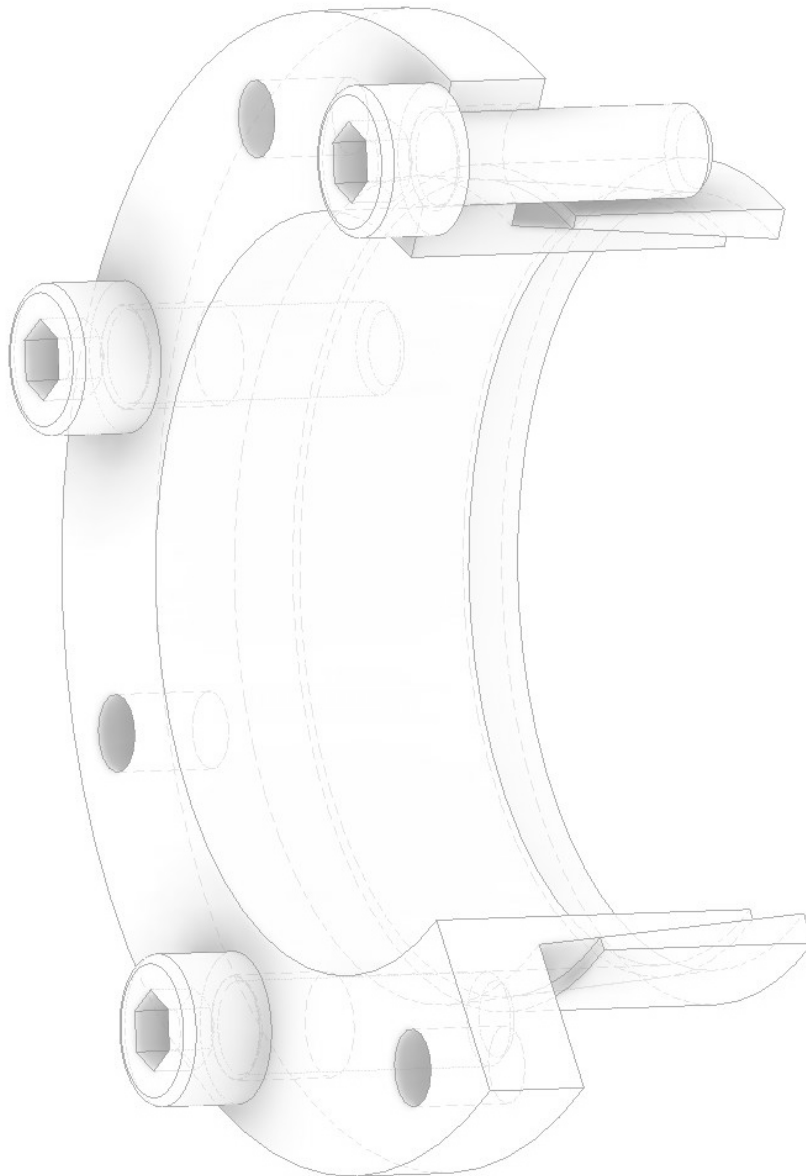

Only available from BIKON-Technik GmbH • 41468 Neuss • Germany

A Development of BIKON-Technik GmbH - introduction on global market in year 1973

## Index:

We reserve all rights with regard to this technical data and its content. Without our prior written approval it is not allowed to duplicate this technical data or parts of it, nor to grant access to it by third parties or to exploit it otherwise (including extracts) without authority.

All topics and specification dealt with are only valid for original „BIKON“ or „DOBIKON“ products.

We will not accept any liability for damages arising from misinterpretation, application or constructional flaws (regarding equipment wherein our products shall be installed). All information is based upon our knowledge of the current state of the art at the draft date of this technical data.

We refer to our trademark and further intellectual property rights as well as our conditions of sale that shall apply.

March 2023

# BIKON 1011

## Shafts with keyways

BIKON Locking assemblies can be tightened over keyways (according to DIN) on shafts. The function of the locking assembly is not affected. **Keyways in the hub are not allowed !**

### Space - BIKON 1003

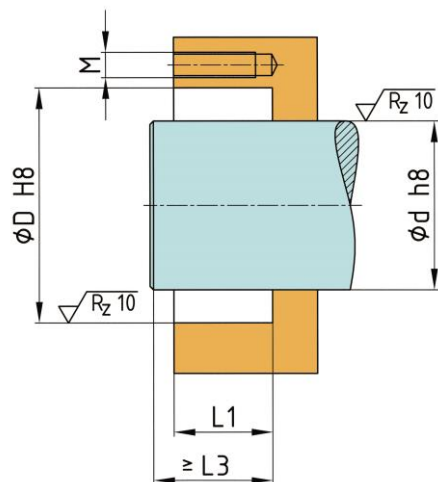

d	D	DT	L1	L3
mm	mm	mm	mm	mm
14	25	33	16	26
15	25	33	16	26
16	25	33	16	26
18	25	33	16	26
19	25	33	16	26
20	30	39	16	26
22	30	39	16	26
24	30	39	16	26
25	36	45	16	26
28	36	45	16	26
30	36	45	16	26
32	42	51	16	28

d	D	DT	L1	L3
mm	mm	mm	mm	mm
35	42	51	16	28
36	42	51	16	28
38	44	54	16	28
40	48	58	16	28
42	48	58	16	28
45	55	67	20	35
48	55	67	20	35
50	62	74	20	35
55	62	74	20	35
60	72	84	20	35
65	72	84	20	35

### TA – Tightening torque os screws

d	M	TA	TA	TA
mm	-	Nm	Nm	Nm
	Güte:	8.8	10.9	12.9
14	M4	2,9	4,1	4,9
15	M4	2,9	4,1	4,9
16	M4	2,9	4,1	4,9
18	M4	2,9	4,1	4,9
19	M4	2,9	4,1	4,9
20	M5	6	8,5	10
22	M5	6	8,5	10
24	M5	6	8,5	10
25	M5	6	8,5	10
28	M5	6	8,5	10
30	M5	6	8,5	10
32	M5	6	8,5	10

d	M	TA	TA	TA
mm	-	Nm	Nm	Nm
	Güte:	8.8	10.9	12.9
35	M5	6	8,5	10
36	M5	6	8,5	10
38	M6	10	14	17
40	M6	10	14	17
42	M6	10	14	17
45	M8	25	35	41
48	M8	25	35	41
50	M8	25	35	41
55	M8	25	35	41
60	M8	25	35	41
65	M8	25	35	41

All BIKON 1011 are installed with 4 screws.

### Please note !

Due to the possible use of different screw classes, it must always be clarified with the technical department which screw class was selected depending on the performance data to be transmitted, in order not to overload the hubs.

## Installation

### 1.

BIKON 1011 are delivered oiled.

The screws are not included.  
Please clarify with the technical department  
which screw class and length is to be used.

Make sure that the rings fit loosely on top of  
each other (self-locking cone).

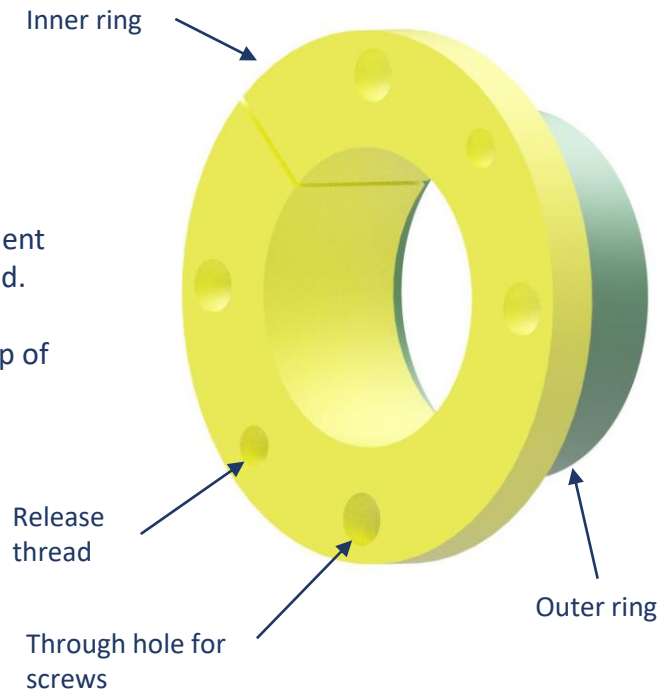

### 2.

Oil the shaft and hub and push the locking assembly into  
the installation space.

**Do not use molybdenum disulfide (MoS<sub>2</sub>), assembly  
paste or grease!**

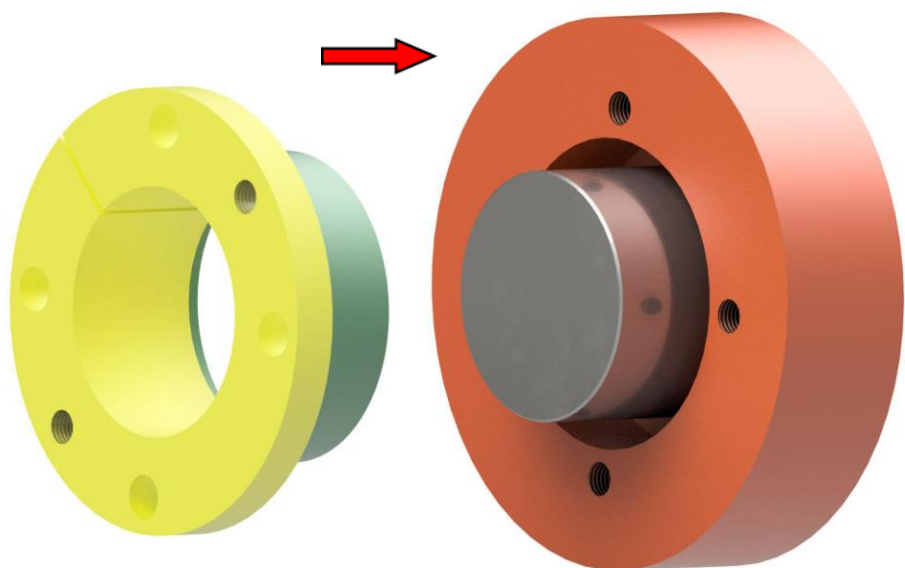

## Installation

3.

The locking assembly (outer ring) must sit flush with the hub. Insert the screws.

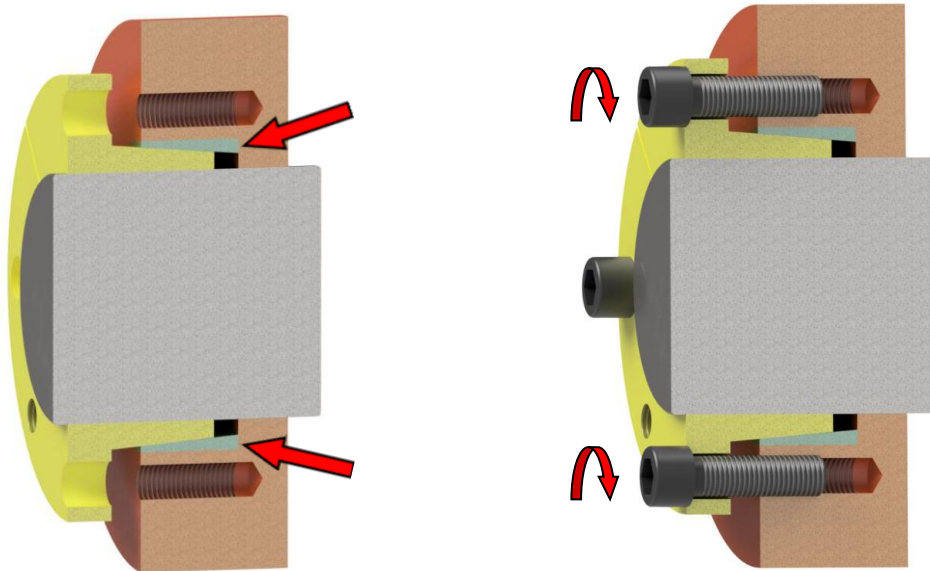

4.

Tighten the screws evenly crosswise and in several stages using a torque wrench.

### control !

The tightening of the screws and the assembly is complete when no more screws can be tightened with the 100% tightening torque.

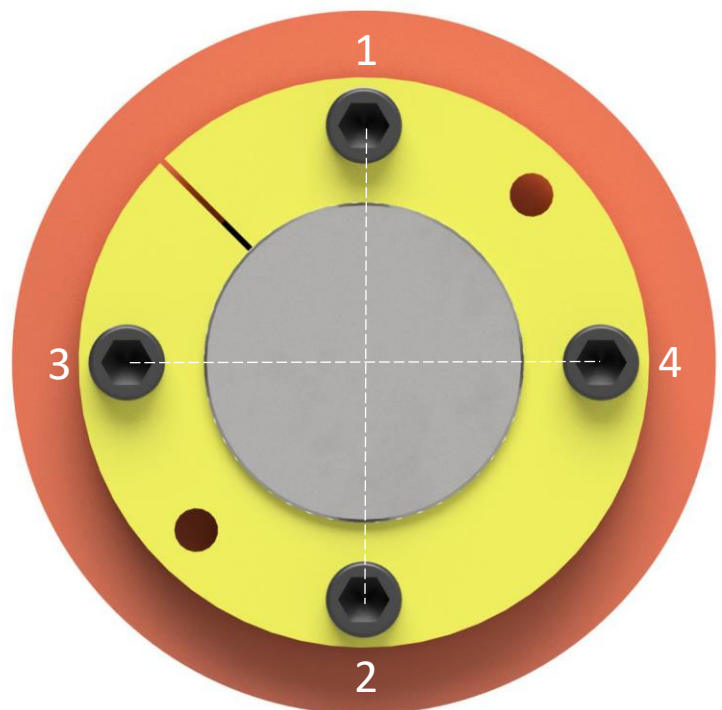

## Installation

5.

By tightening the screws, the outer ring slides and tightens the connection. The cone is self-locking and will not loosen by itself if the screws are loosened if it is operated properly.

### Please note !

The hub moves in the axial direction with the outer ring!

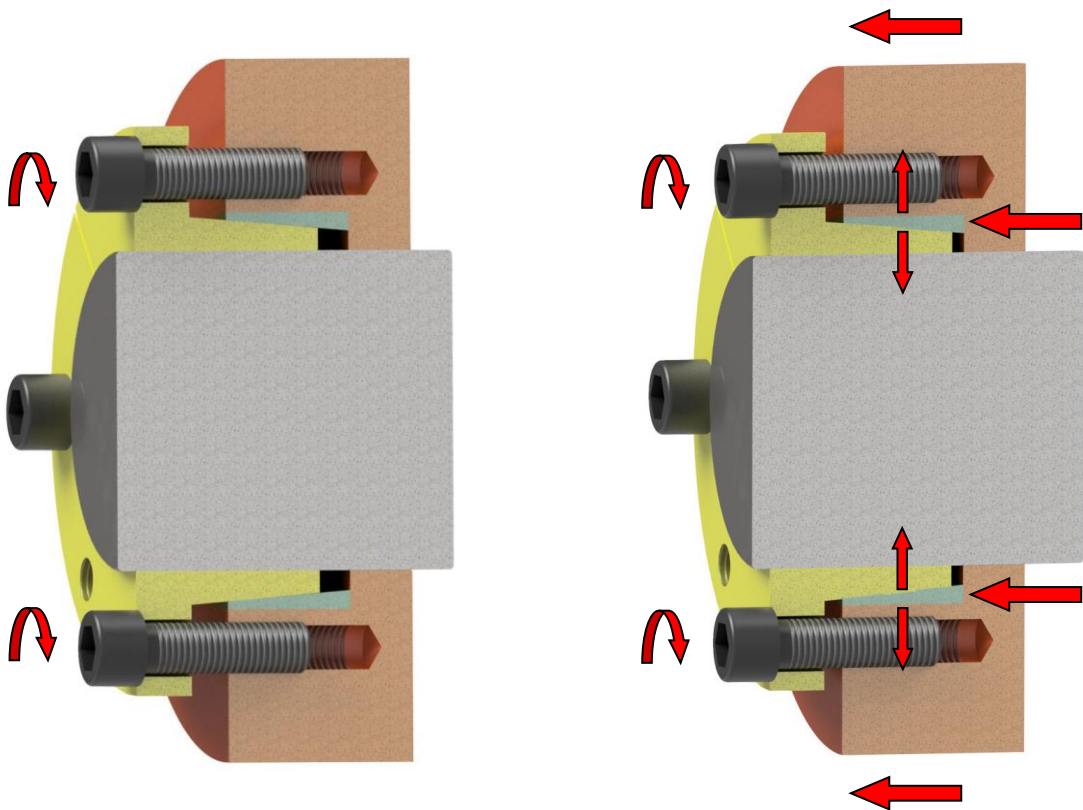

The locking assembly is maintenance-free and the screws do not have to be tightened after a certain period of operation.



## Removal

### 1.

Loosen all screws a few threads.  
Unscrew as many screws as there are release threads.

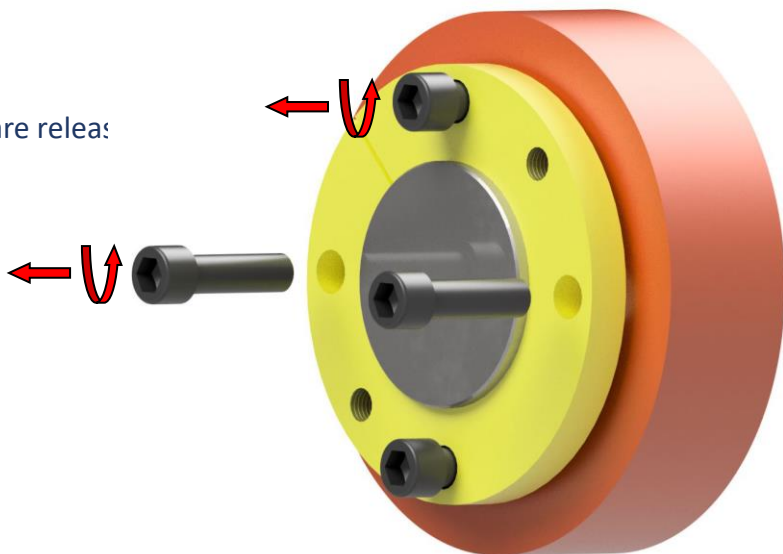

### 2.

Oil the screws and screw them into the release threads and tighten them crosswise with a torque wrench until the outer ring slides off the inner ring.

(Grind the release screws flat on the face side before screwing them in)

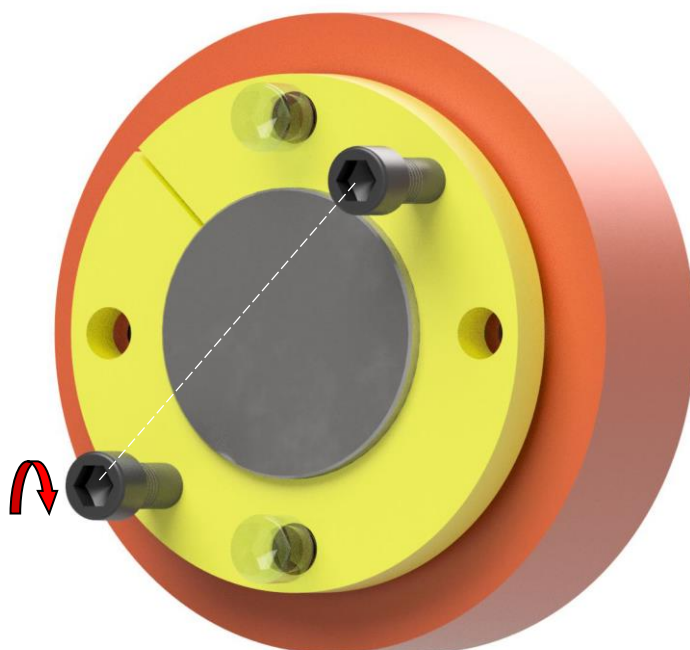

## Removal

3.  
The outer ring slides off the inner ring together with the hub.

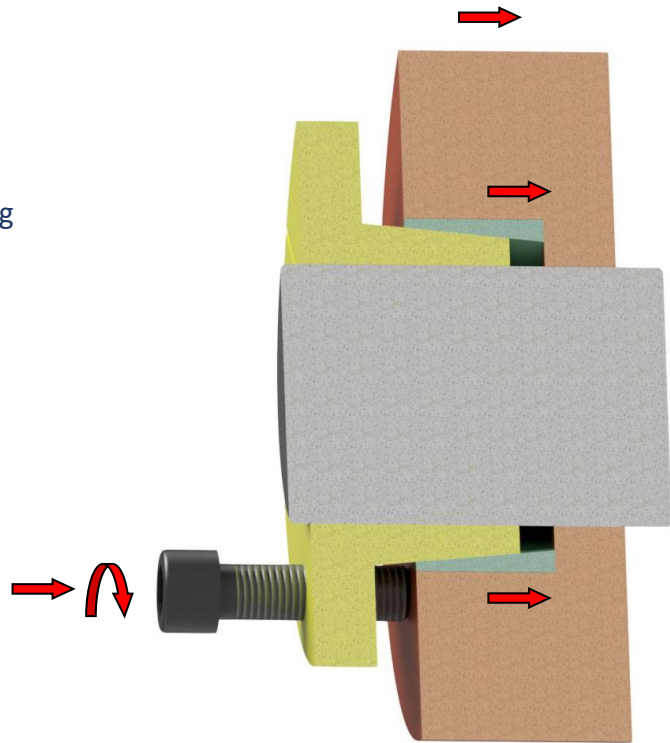

4.  
Remove the locking assembly from the space.

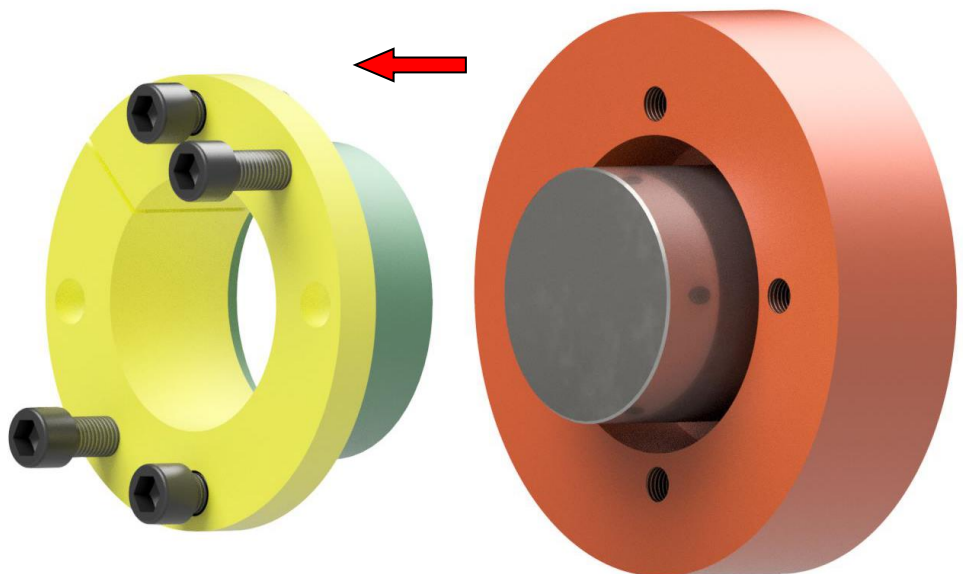

### Reusability

Undamaged locking assemblies can be reused.

**The screws must be changed after each use!**



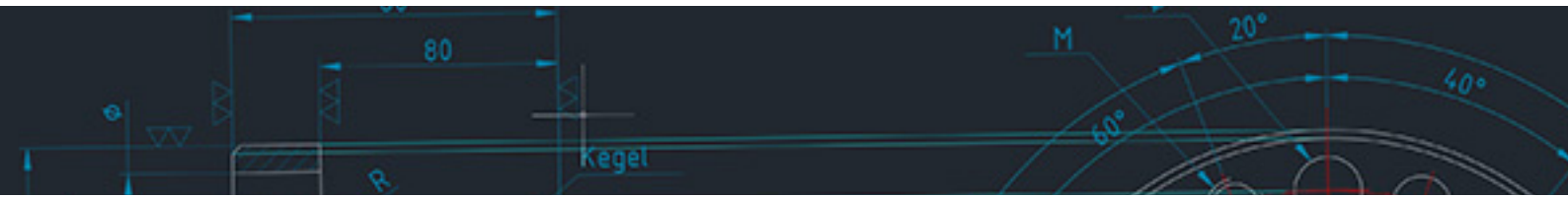

# BIKON-Technik GmbH

Hansemannstrasse 11

41468 Neuss • Germany

Tel. ++49 (0) 2131-71889-0

[www.bikon.de](http://www.bikon.de)

E-Mail [info@bikon.de](mailto:info@bikon.de)