

**BIKON 1007**  
Installation Manual

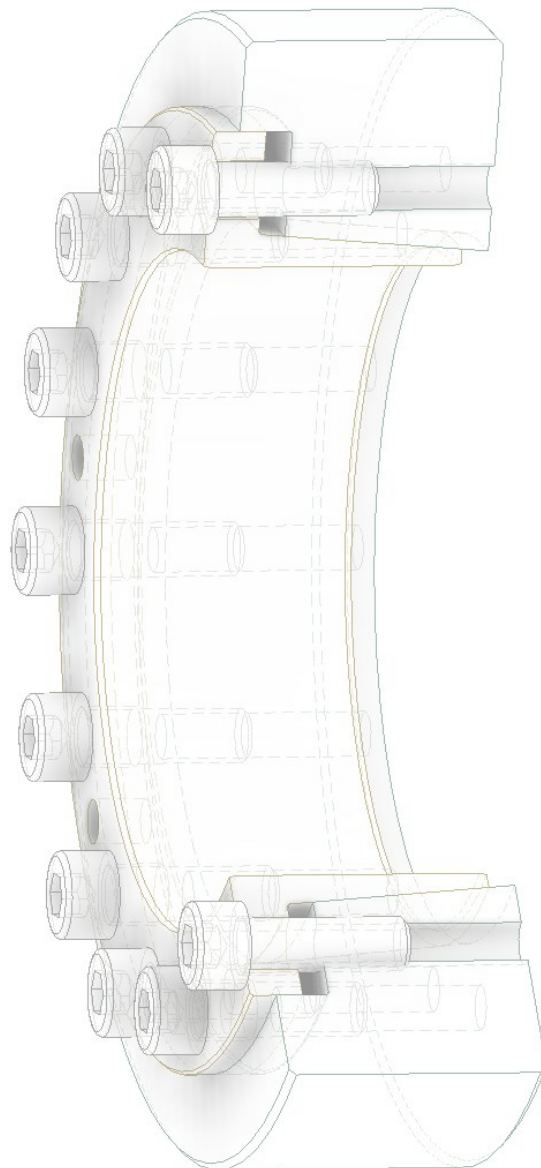

Only available from BIKON-Technik GmbH • 41468 Neuss • Germany

## Index:

We reserve all rights with regard to this technical data and its content. Without our prior written approval it is not allowed to duplicate this technical data or parts of it, nor to grant access to it by third parties or to exploit it otherwise (including extracts) without authority.

All topics and specification dealt with are only valid for original „BIKON“ or „DOBIKON“ products.

We will not accept any liability for damages arising from misinterpretation, application or constructional flaws (regarding equipment wherein our products shall be installed). All information is based upon our knowledge of the current state of the art at the draft date of this technical data.

We refer to our trademark and further intellectual property rights as well as our conditions of sale that shall apply.

April 2023

## Space - BIKON 1007

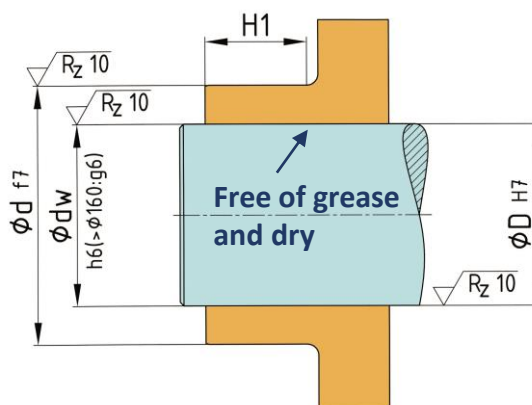

d	D	H1
mm	mm	mm
18	44	15
20	47	15
24	50	18
30	60	20
36	72	22
44	80	24
50	90	26
55	100	29
62	110	29
68	115	29
75	138	31
82	145	31
85	155	38
90	155	38
95	170	43

d	D	H1
mm	mm	mm
100	170	43
105	185	49
110	185	49
110	200	49
115	200	49
120	215	53
125	215	53
130	215	53
135	230	58
140	230	58
150	263	62
155	263	62
160	263	62
165	290	68
170	290	68

d	D	H1
mm	mm	mm
175	300	68
180	300	68
185	330	85
190	330	85
195	350	85
200	350	85
210	370	103
220	370	103
230	405	107
240	405	107
250	430	119
260	430	119
280	460	132
300	485	140
320	520	140

d	D	H1
mm	mm	mm
340	570	155
350	580	162
360	590	162
380	640	166
390	650	166
420	670	186
440	720	194
460	770	194
480	800	213
500	850	213
530	910	238
560	940	238
590	960	260
620	970	286
660	1070	292

## TA – Tightening torque of screws

d	M	TA
mm	-	Nm
18	M5	7
20	M5	7
24	M5	7
30	M5	7
36	M6	17
44	M6	17
50	M6	17
55	M6	17
62	M6	17
68	M6	17
75	M8	41
82	M8	41
85	M8	41
90	M8	41
95	M8	41

d	M	TA
mm	-	Nm
100	M8	41
105	M10	83
110	M10	83
110	M10	83
115	M10	83
120	M10	83
125	M10	83
130	M10	83
135	M12	145
140	M12	145
150	M12	145
155	M12	145
160	M12	145
165	M16	355
170	M16	355

d	M	TA
mm	-	Nm
175	M16	355
180	M16	355
185	M16	355
190	M16	355
195	M16	355
200	M16	355
210	M16	355
220	M16	355
230	M20	690
240	M20	690
250	M20	690
260	M20	690
280	M20	690
300	M24	1 200
320	M24	1 200

d	M	TA
mm	-	Nm
340	M24	1 200
350	M24	1 200
360	M24	1 200
380	M27	1 800
390	M27	1 800
420	M27	1 800
440	M27	1 800
460	M27	1 800
480	M30	2 400
500	M30	2 400
530	M30	2 400
560	M30	2 400
590	M30	2 400
620	M30	2 400
660	M33	3 200

## Installation

### 1.

BIKON 1007 are delivered ready for installation and oiled.  
The screws have been unscrewed a few threads.

Make sure that the rings fit loosely on top of each other (self-locking cone).

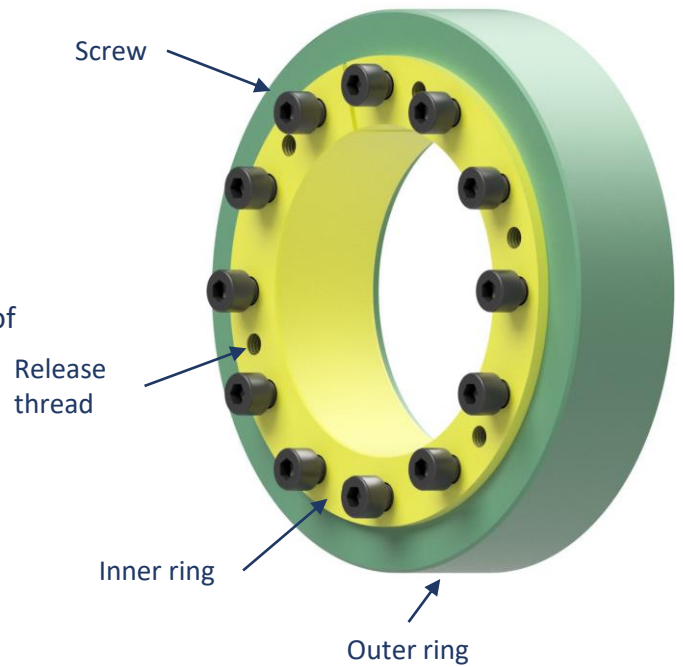

### 2.

Join the shaft and inner bore of the hub dry and free of grease.  
Slide the shrink disk (oiled) onto the hub.

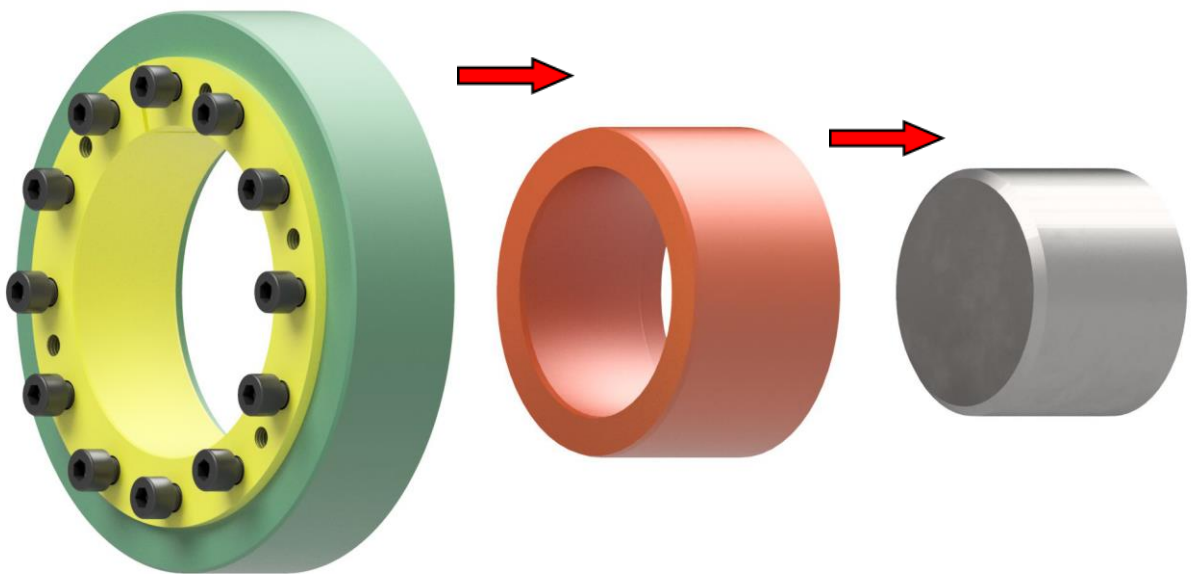

## Installation

### 3.

The hub and shrink disc must not protrude over the shaft.  
Minimum flush fit required.

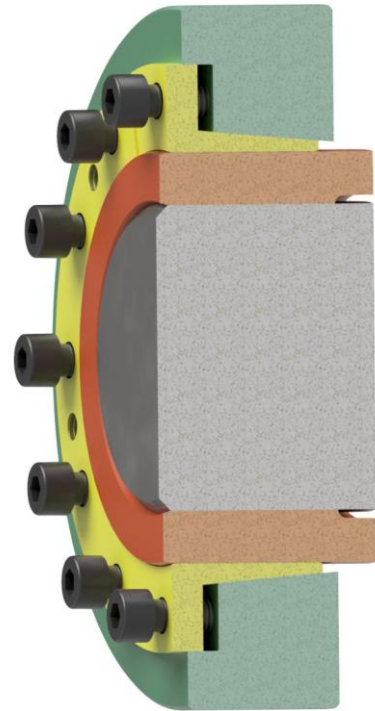

### 4.

Tighten the screws evenly crosswise and in several stages using a torque wrench.

#### **control !**

The tightening of the screws and the assembly is complete when no more screws can be tightened with the 100% tightening torque.

#### **Attention !**

Do not clamp a shrink disc without an installed shaft, otherwise plastic deformation of the hub is possible.

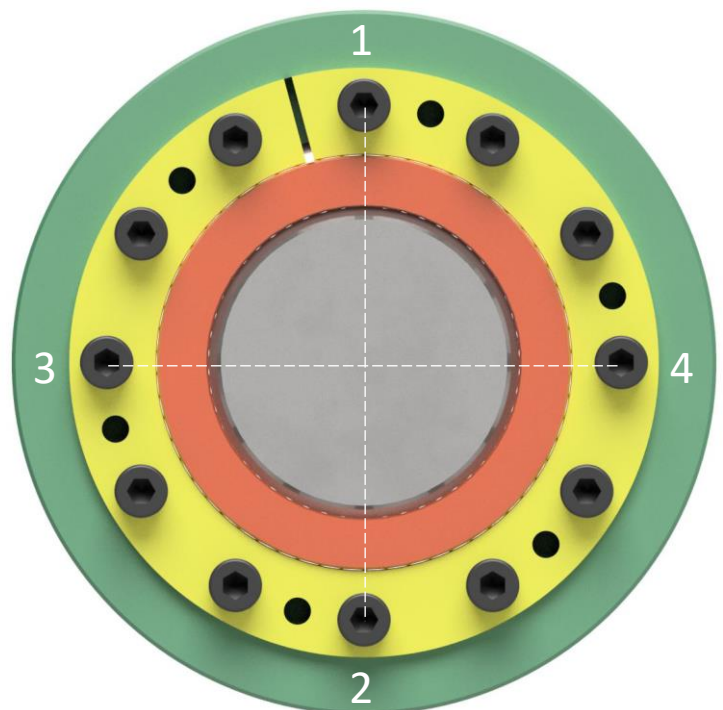

## Installation

5.

By tightening the screws, the outer ring slides and tightens the connection. The cone is self-locking and will not loosen by itself if the screws are loosened if it is operated properly.

The hub does not move in the axial direction during assembly.

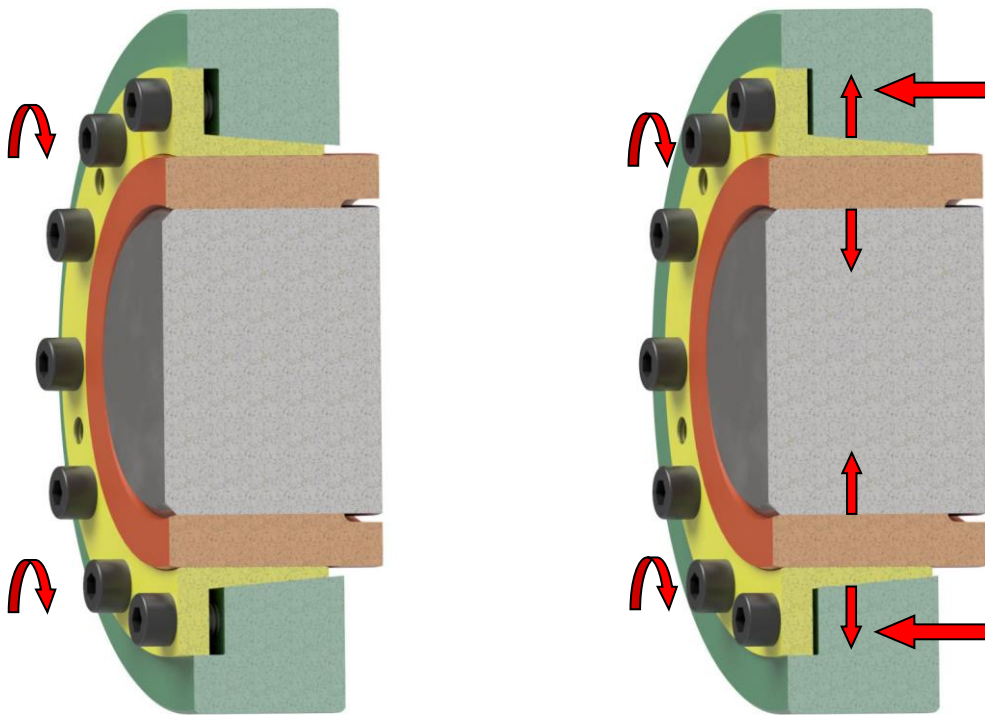

The shrink disk is maintenance-free and the screws do not have to be tightened after a certain period of operation.

## Removal

### 1.

Loosen all screws a few threads.  
Unscrew as many screws as there are relea threads.

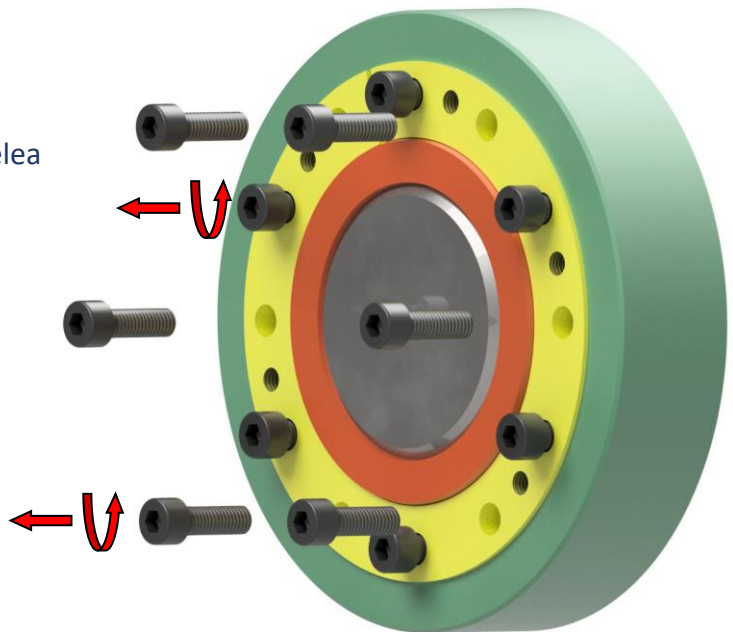

### 2.

Oil the screws and screw them into the release threads and tighten them crosswise with a torque wrench until the outer ring slides off the inner ring.

(Grind the release screws flat on the face side before screwing them in)

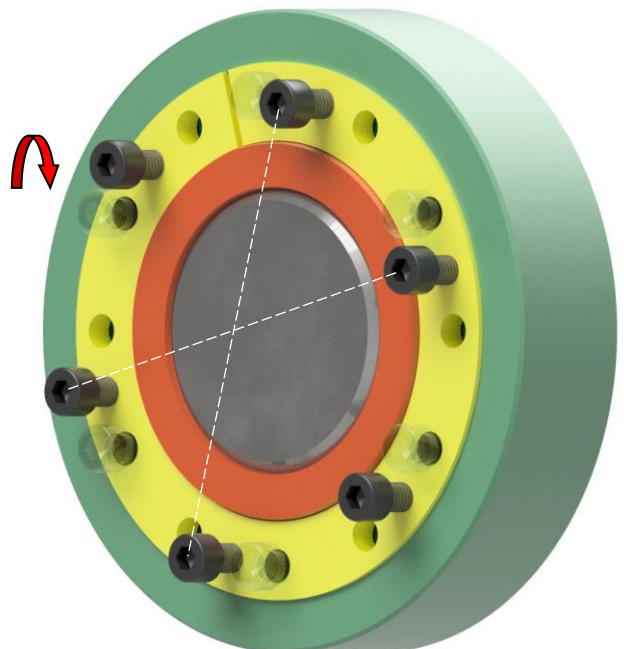

## Removal

3.  
The outer ring slides off the inner ring.

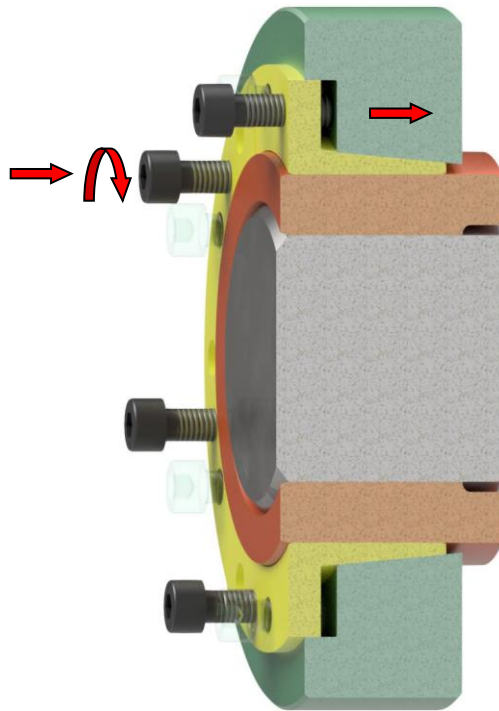

4.  
Remove the shrink disk from the hub and the hub from the shaft.

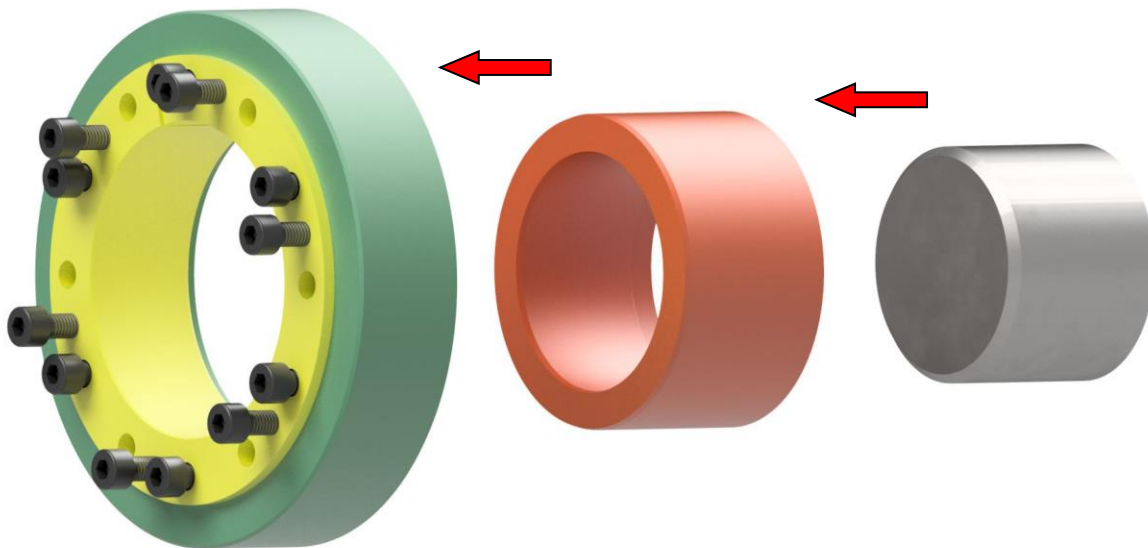

### Reusability

Undamaged locking assemblies can be reused.

**The screws must be changed after each use!**



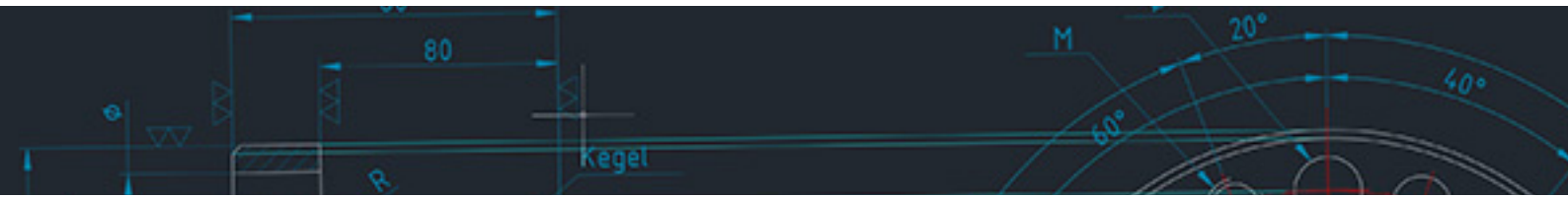

# BIKON-Technik GmbH

Hansemannstrasse 11

41468 Neuss • Germany

Tel. ++49 (0) 2131-71889-0

[www.bikon.de](http://www.bikon.de)

E-Mail [info@bikon.de](mailto:info@bikon.de)