

**BIKON 1003**  
Installation Manual

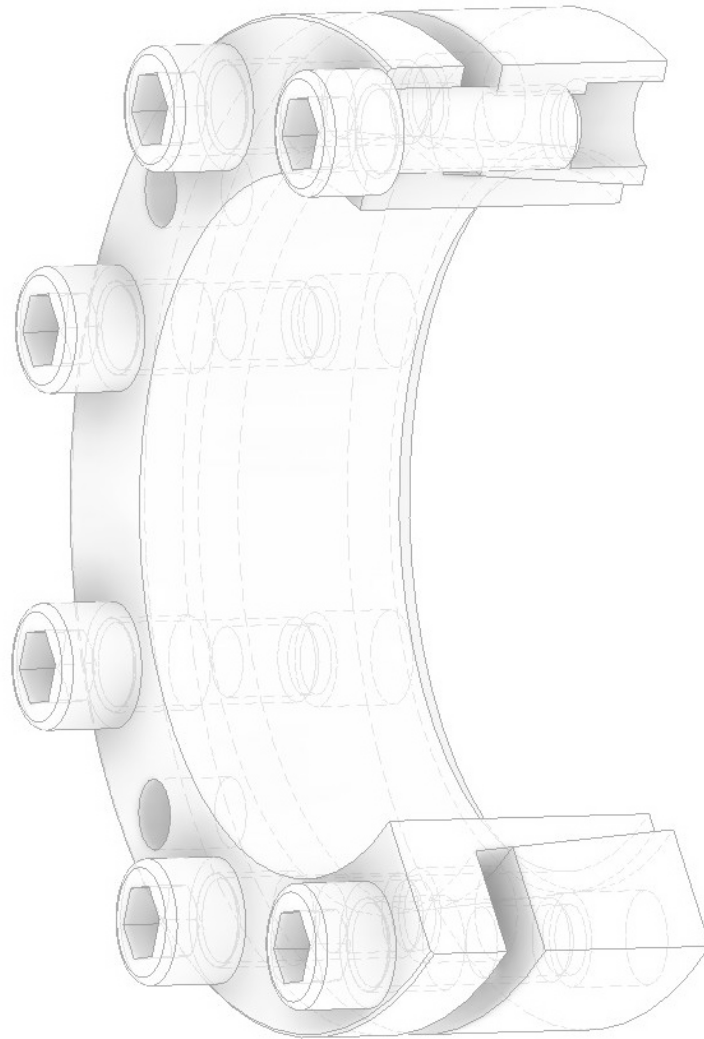

Only available from BIKON-Technik GmbH • 41468 Neuss • Germany

A development of BIKON-Technik GmbH - introduction on global market in year 1973

## Index:

We reserve all rights with regard to this technical data and its content. Without our prior written approval it is not allowed to duplicate this technical data or parts of it, nor to grant access to it by third parties or to exploit it otherwise (including extracts) without authority.

All topics and specification dealt with are only valid for original „BIKON“ or „DOBIKON“ products.

We will not accept any liability for damages arising from misinterpretation, application or constructional flaws (regarding equipment wherein our products shall be installed). All information is based upon our knowledge of the current state of the art at the draft date of this technical data.

We refer to our trademark and further intellectual property rights as well as our conditions of sale that shall apply.

February 2023

# BIKON 1003

Schematic scetch

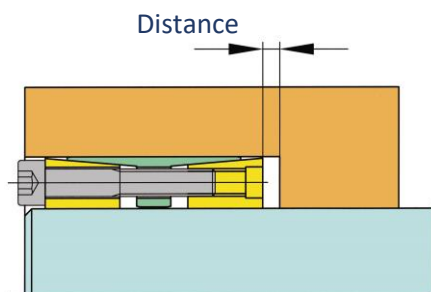

## Space - generally

By use of stepped bores the locking assembly should never be pushed to block against the hub. There must be let distance about 2 – 5 mm to the hub to be able to remove the rings from each other. This applies to all BIKON locking assemblies.

## Shafts with keyways

BIKON Locking assemblies can be tighten over keyways (according to DIN) on shafts. The function of the locking assembly is not affected.

**Keyways in the hub are not allowed !**

## Space - BIKON 1003

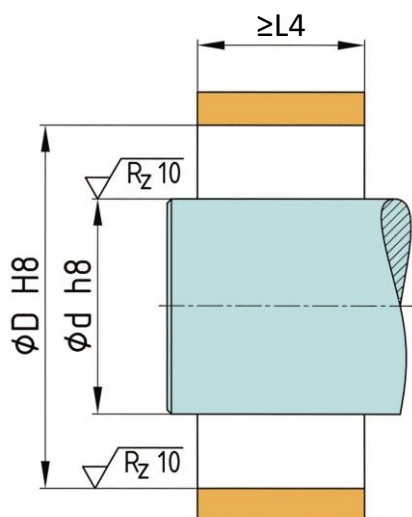

d	D	L4	d	D	L4	d	D	L4
mm	mm	mm	mm	mm	mm	mm	mm	mm
19	47	28	63	95	33	190	250	65
20	47	28	65	95	33	200	260	65
22	47	28	70	110	40	220	285	74
24	50	28	75	115	40	240	305	74
25	50	28	80	120	40	260	325	74
28	55	28	85	125	40	280	355	88
30	55	28	90	130	40	300	375	88
32	60	28	95	135	40	320	405	105
35	60	28	100	145	44	340	425	105
38	65	28	110	155	44	360	455	120
40	65	28	120	165	44	380	475	120
42	75	33	130	180	52	400	495	120
45	75	33	140	190	54	420	515	120
48	80	33	150	200	54	440	535	120
50	80	33	160	210	54	460	555	120
55	85	33	170	225	65	480	575	120
60	90	33	180	235	65	500	595	120

## TA – Tightening torque of screws

d	M	TA	d	M	TA	d	M	TA	d	M	TA
mm	-	Nm	mm	-	Nm	mm	-	Nm	mm	-	Nm
19	M6	14	48	M8	35	110	M12	125	280	M18	405
20	M6	14	50	M8	35	120	M12	125	300	M18	405
22	M6	14	55	M8	35	130	M12	125	320	M20	580
24	M6	14	60	M8	35	140	M14	190	340	M20	580
25	M6	14	63	M8	35	150	M14	190	360	M22	780
28	M6	14	65	M8	35	160	M14	190	380	M22	780
30	M6	14	70	M10	70	170	M14	190	400	M22	780
32	M6	14	75	M10	70	180	M14	190	420	M22	780
35	M6	14	80	M10	70	190	M14	190	440	M22	780
38	M6	14	85	M10	70	200	M14	190	460	M22	780
40	M6	14	90	M10	70	220	M16	295	480	M22	780
42	M8	35	95	M10	70	240	M16	295	500	M22	780
45	M8	35	100	M12	125	260	M16	295			

## Installation

1. BIKON locking assemblies are delivered ready for installation and oiled. The screws have been unscrewed a few threads.

Make sure that the rings fit loosely on top of each other (self-locking cone).

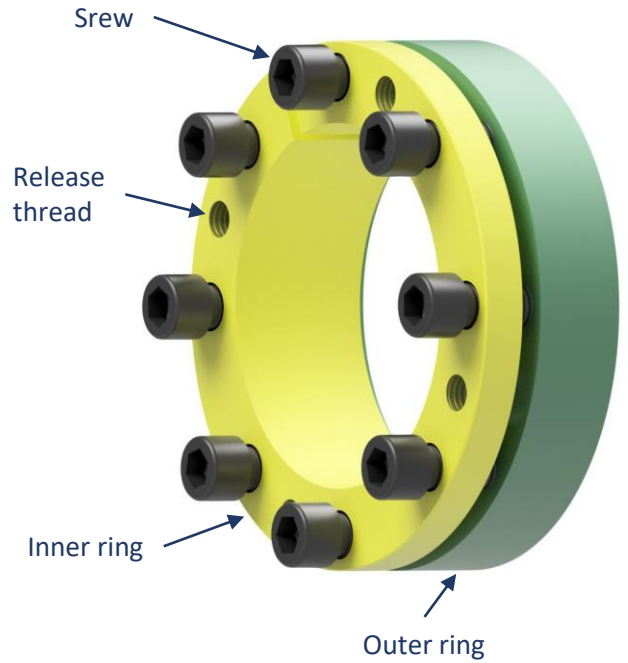

2. Oil the shaft and hub and push the locking assembly into the installation space.

**Do not use molybdenum disulfide (MoS<sub>2</sub>), assembly paste or grease!**

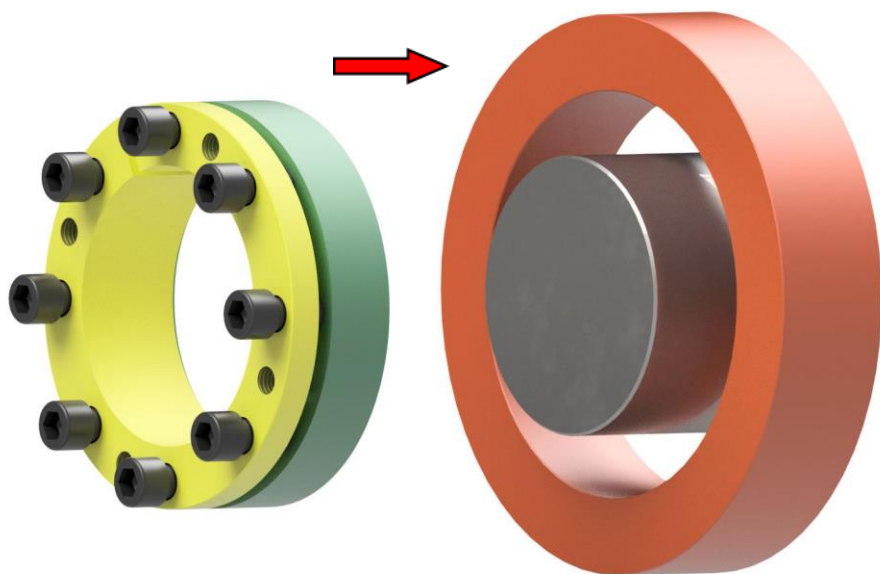

## Installation

**3.**

The locking assembly must sit flush with the hub.

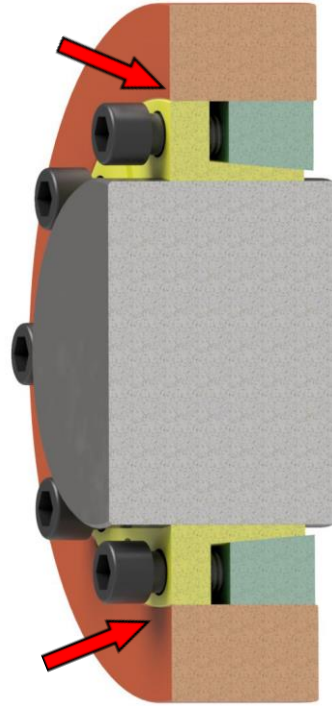

**4.**

Tighten the screws evenly crosswise and in several stages using a torque wrench.

### **control !**

The tightening of the screws and the assembly is complete when no more screws can be tightened with the 100% tightening torque.

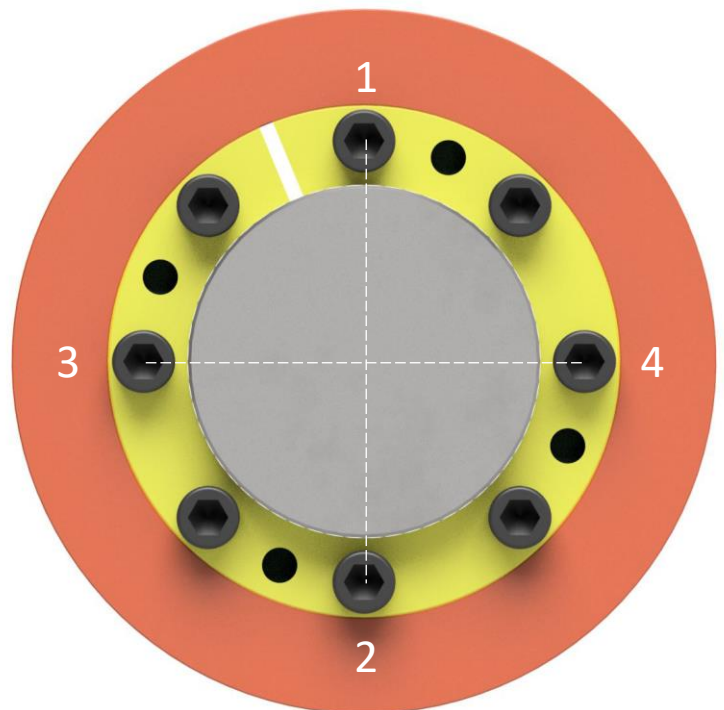

## Installation

5.

By tightening the screws, the outer ring slides and tightens the connection. The cone is self-locking and will not loosen by itself if the screws are loosened if it is operated properly.

### Please note !

The hub moves in the axial direction with the outer ring!

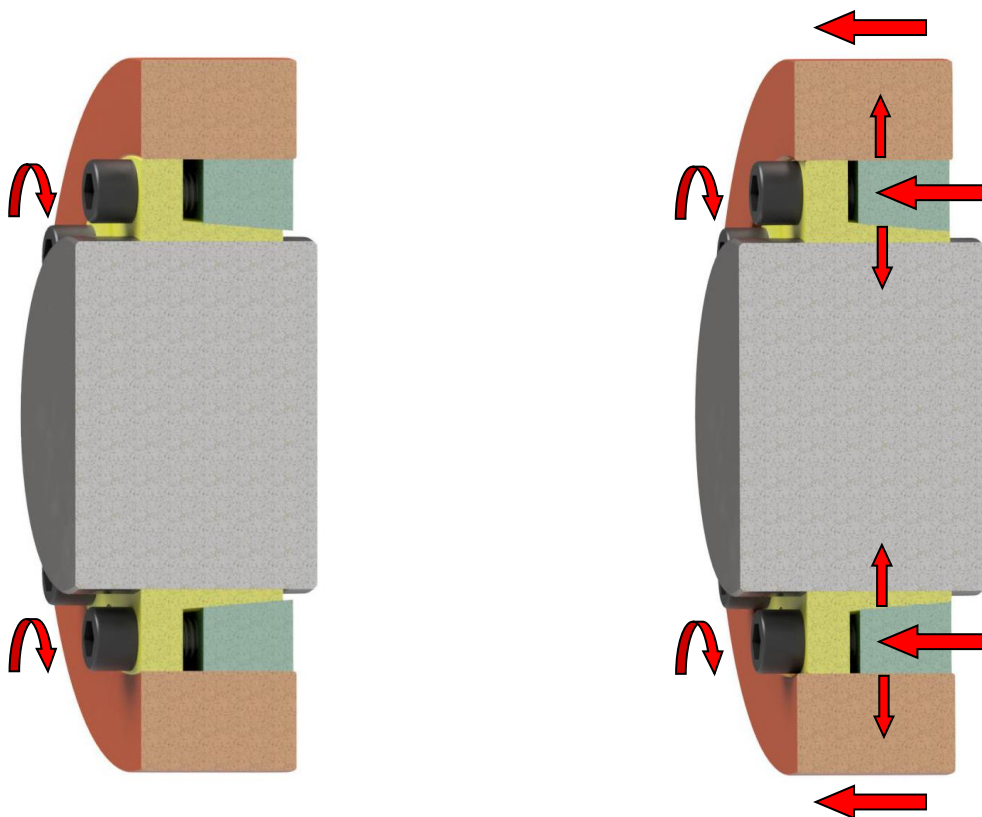

The locking assembly is maintenance-free and the screws do not have to be tightened after a certain period of operation.



## Removal

### 1.

Loosen all screws a few threads.  
Unscrew as many screws as there are release threads.

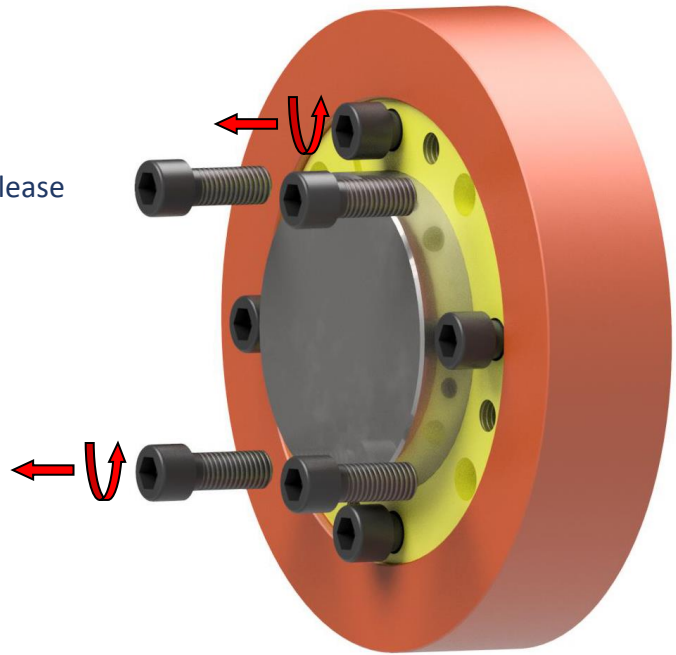

### 2.

Oil the screws and screw them into the release threads and tighten them crosswise with a torque wrench until the outer ring slides off the inner ring.

(Grind the release screws flat on the face side before screwing them in)

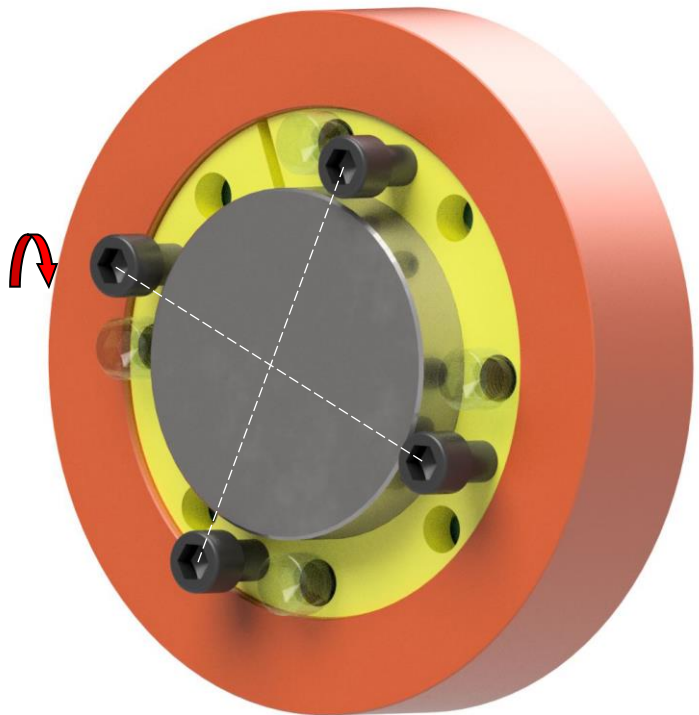

## Removal

3.  
The outer ring slides off the inner ring together with the hub.

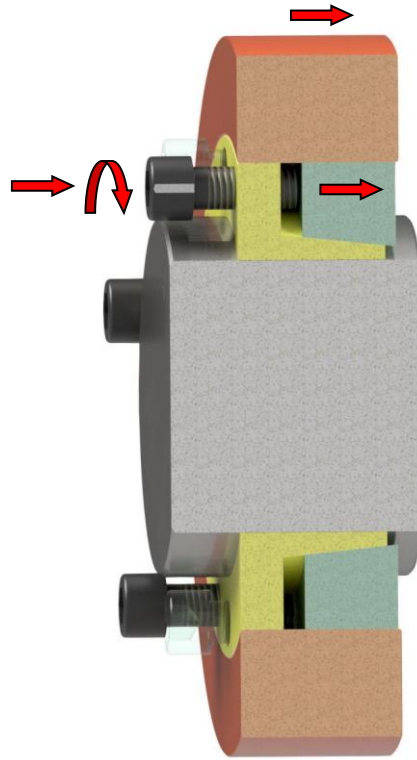

4.  
Remove the locking assembly from the space.

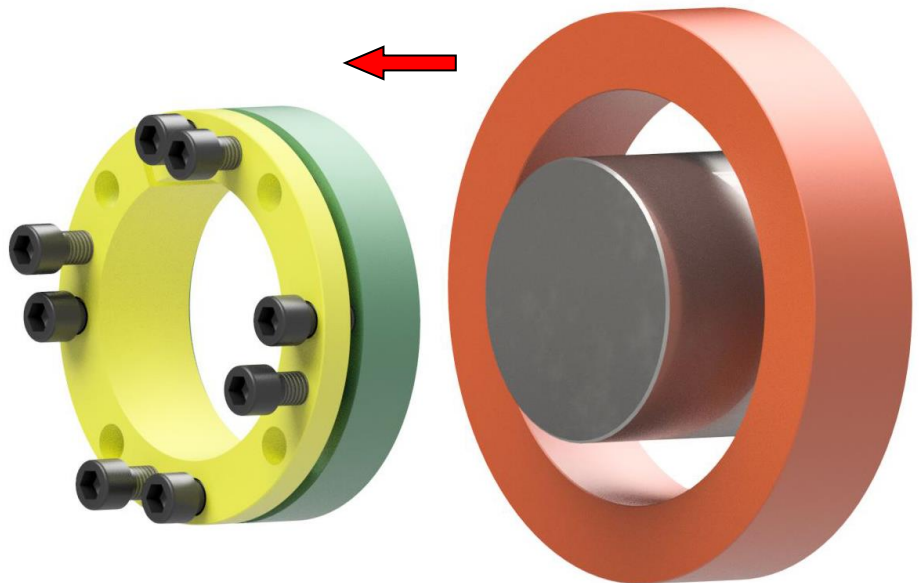

## Reusability

Undamaged locking assemblies can be reused.

**The screws must be changed after each use!**



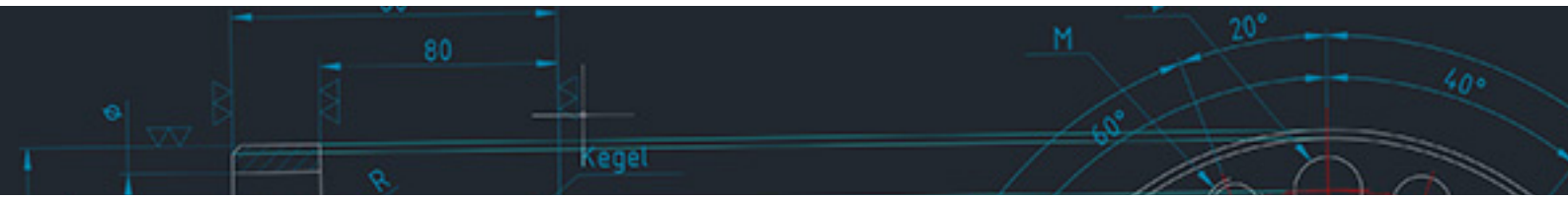

## **BIKON-Technik GmbH**

Hansemannstrasse 11

41468 Neuss • Germany

Tel. ++49 (0) 2131-71889-0

[www.bikon.de](http://www.bikon.de)

E-Mail [info@bikon.de](mailto:info@bikon.de)